



Department of Building & Grounds
Architectural Services Division

City of Baton Rouge
Parish of East Baton Rouge

P.O. Box 1471
Baton Rouge, Louisiana 70821
225 389-4694 Voice
225 389-4704 Fax

ADDENDUM #1

April 22, 2024

TO ALL BIDDERS

**PROJECT: New Surface Parking Lot
St. Ferdinand Street, Baton Rouge, LA 70802
CITY PARISH PROJECT NO. 20-ASC-CP-1515**

The following revisions shall be incorporated in and take precedence over any conflicting part of the original contract documents.

Please see attach addendum regarding added electrical scope to the project.

TOTAL PAGES4 (including this page)

FAILURE TO INDICATE RECEIPT OF THIS ADDENDUM ON BID FORM MAY BE CAUSE FOR THE BID TO BE REJECTED

Sean M. Johnson, AIA
Chief Architect
Architectural Services Division
1100 Laurel Street, Rm 227
Baton Rouge, LA 70802



7600 Innovation Park Drive

Baton Rouge, LA 70820

P: 225.332.0222

parisheng.com | contact@parisheng.com

April 17, 2024

New Downtown Surface Lot – St. Ferdinand Street

Baton Rouge, LA

La Terre Engineering, LLC Proj. No. 2021-02

ADDENDUM #1

The following items shall be considered part of the Contract Documents for the above referenced project and shall take precedence over any conflicting statements contained therein. Revise all other notes, schedules, details, elevations, and sections as required.

ELECTRICAL ITEMS:

Drawings:

1. Sheet Number E1.0
 - a. Added 1" conduit for future digital signage and included associated notes.
2. Sheet Number E2.0
 - a. Added circuits for future digital signage to the schedule for panel "LA".

If you have any questions, please contact our office.

Parish Engineering, LLC

Attachments:

Sheets E1.0, E2.0

REVISIONS	NO.	BY	DATE	REMARKS
	1	SPG	04/17/24	ADDENDUM #1

SHEET INFO	
DRAWN	DTB
CHECKED	SPG
APPROVED	SPG
LAST EDIT	10/12/2023
PLOT DATE	10/12/2023
SUBMITTAL	

SITE PLAN
NEW DOWNTOWN SURFACE LOT - ST FERDINAND STREET
 CITY OF BATON ROUGE - PARISH OF EAST BATON ROUGE
 CITY PARISH PROJECT NO. 21-ASD-CP-1380
 SCALE AS SHOWN
 DRAWING FILE NAME: ELECTRICAL PLAN
 PROJECT NUMBER: 2021-02

SHEET NUMBER
E1.0

LOUISIANA AVENUE

ST. FERDINAND STREET

ST. LOUIS STREET

- ELECTRICAL KEYNOTES**
- 1 MOUNT INTEGRAL OCCUPANCY SENSOR AND PHOTOCELL AT 25'-0" AFF.
 - 2 CAR CHARGING PEDESTAL. THIS PEDESTAL SHALL BE PROVIDED WITH TWO (2) 60A/2P CHARGING PORTS.
 - 3 CAR CHARGING PEDESTAL. THIS PEDESTAL SHALL BE PROVIDED WITH ONE (1) 60A/2P CHARGING PORT.
 - 4 IN-GROUND PULL BOX. SPLICE CHARGER FEEDERS WITHIN BOX. SEE DETAIL #2 ON SHEET E2.0.

CONTRACTOR'S ATTENTION:
 CONDUIT AND WIRE SIZES SHOWN FOR PARKING LOT LIGHTING AND FOR CHARGER FEEDERS TO THE PULL BOX ARE UPSIZED DUE TO VOLTAGE DROP.

ROUTE CIRCUITS FOR CAR CHARGERS AS SHOWN; AVOID DISTURBANCE OF EXISTING UNDERGROUND UTILITIES; FEEDERS SHALL BE AS FOLLOWS:
 ONE (1) 1-1/4" C, 2#2 THWN & 1#4 GND FOR SINGLE CHARGER PEDESTAL
 TWO (2) 1-1/4" C, 2#2 THWN & 1#4 GND FOR ONE (1) DUAL CHARGER PEDESTAL
 TWO (2) 1-1/4" C, 2#2 THWN & 1#4 GND FOR ONE (1) DUAL CHARGER PEDESTAL
 TOTAL OF FIVE (5) FEEDERS

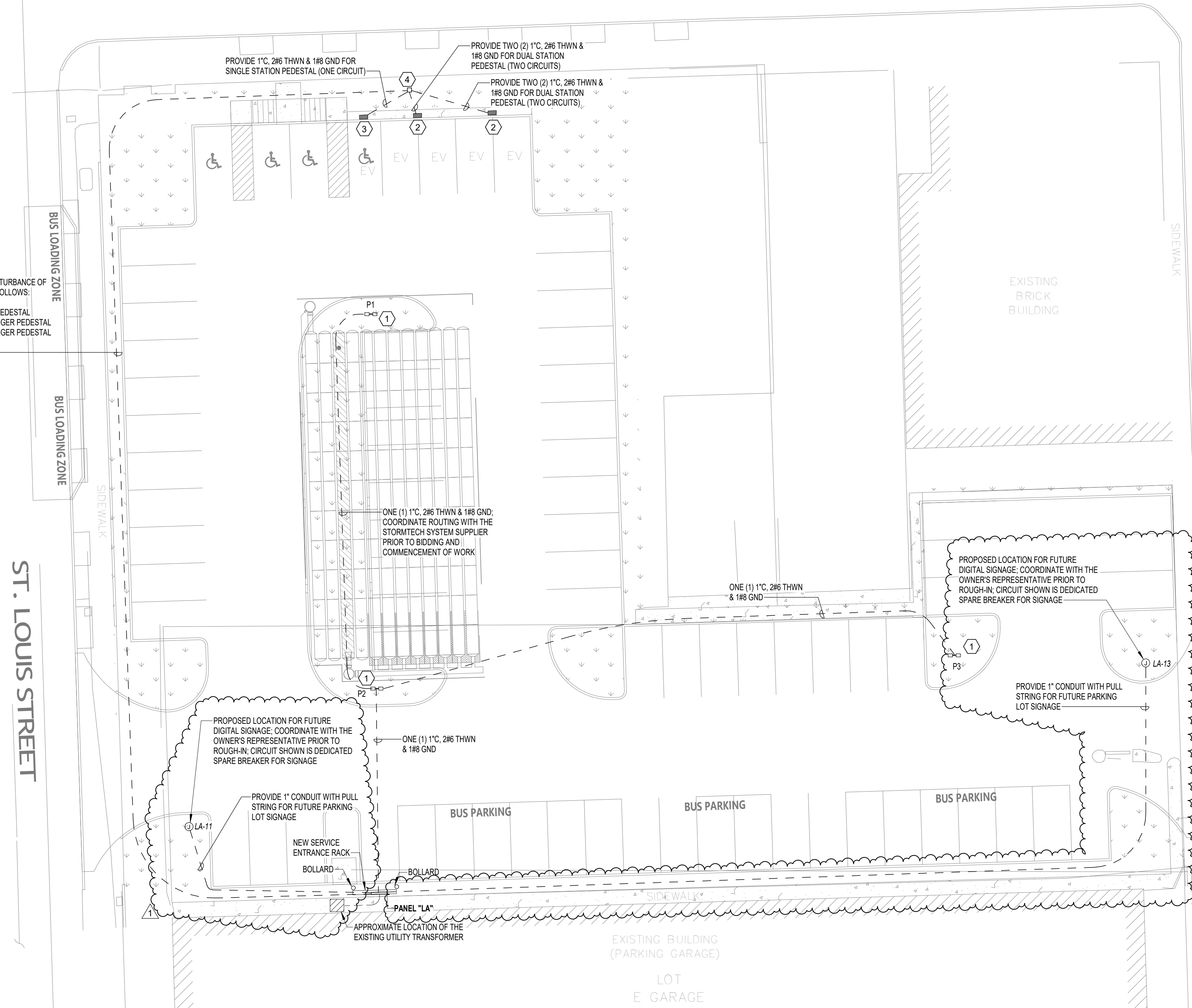

1 ELECTRICAL SITE PLAN
 1/16" = 1'-0"

SCHEDULE - LIGHTING FIXTURES

NOTES:
 ** FINISH TO BE SELECTED BY ARCHITECT

MARK	DESCRIPTION	LAMPS	VOLTS	LOAD	TEMP.	LUMENS	MOUNTING	BASIS OF DESIGN		ACCEPTABLE ALTERNATIVE		COUNT
								MANUFACTURER	CATALOG NO.	ALTERNATE MANUFACTURER	ALTERNATE CATALOG NO.	
P	25' TALL, 5" SQUARE STRAIGHT STEEL POLE WITH TWO (2) LED FIXTURES MOUNTED AT 180 DEGREES; FIXTURES SHALL HAVE INTEGRAL OCCUPANCY SENSORS AND PHOTOELECTRIC CELLS	LED	120	400 VA	40K	28,000	POLE	LSI INDUSTRIES (FIXTURE); AMERICAN LITE POLE (POLE)	SMA-LED-28L-ACR-FT-UNV-40-IMSBT1 (FIXTURE); SNS-25-50-11-AB-DM28 (POLE)	CREE LIGHTING (FIXTURE); LITHONIA LIGHTING (POLE)	OSQ-L-30L-40K7-4M-UL-OSO-ML-C-DA-**-W5M-4-0PM (FIXTURE); SSS-25-5C-DM28-** (POLE)	3

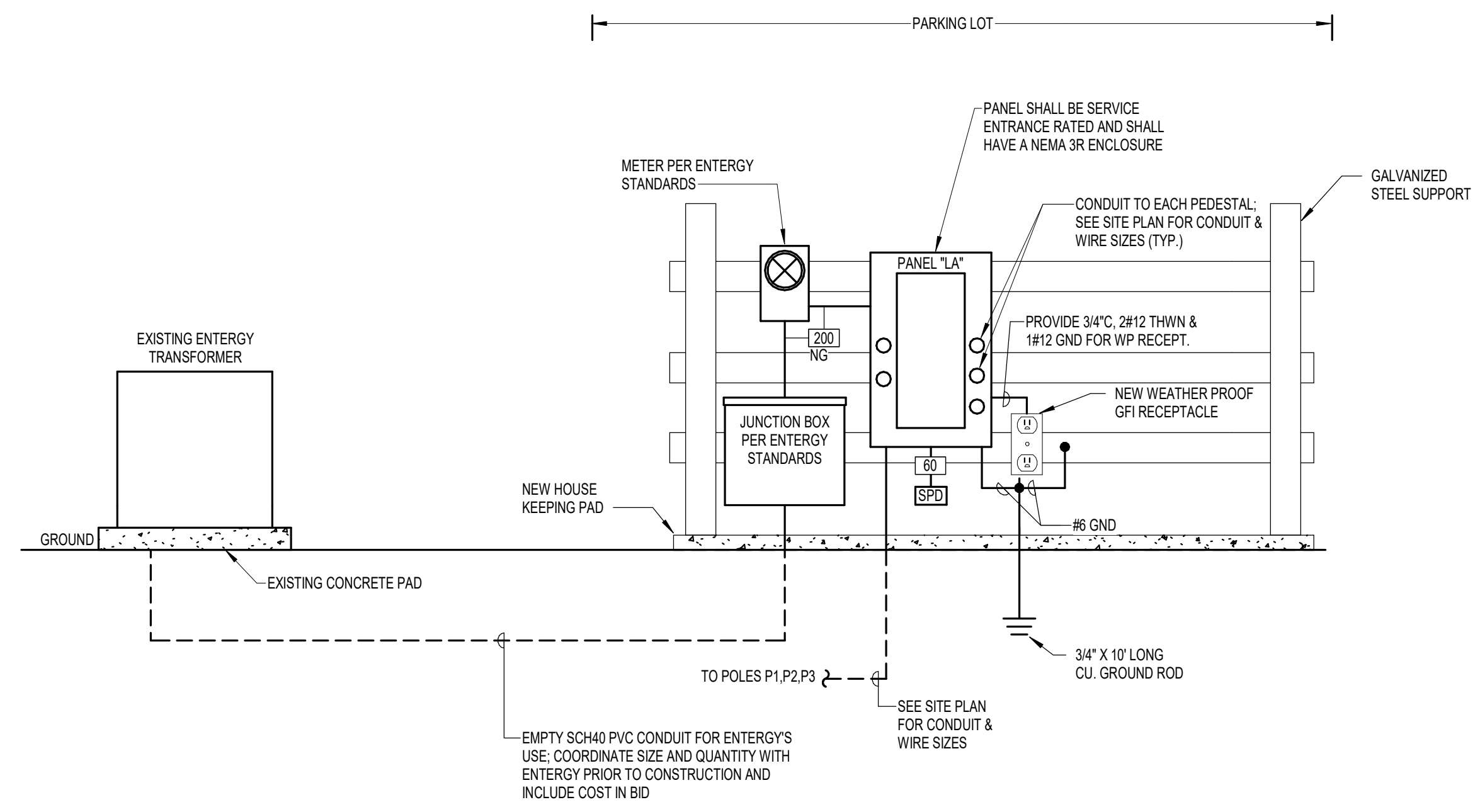

1 POWER RISER DIAGRAM - PARKING LOT
N.T.S.

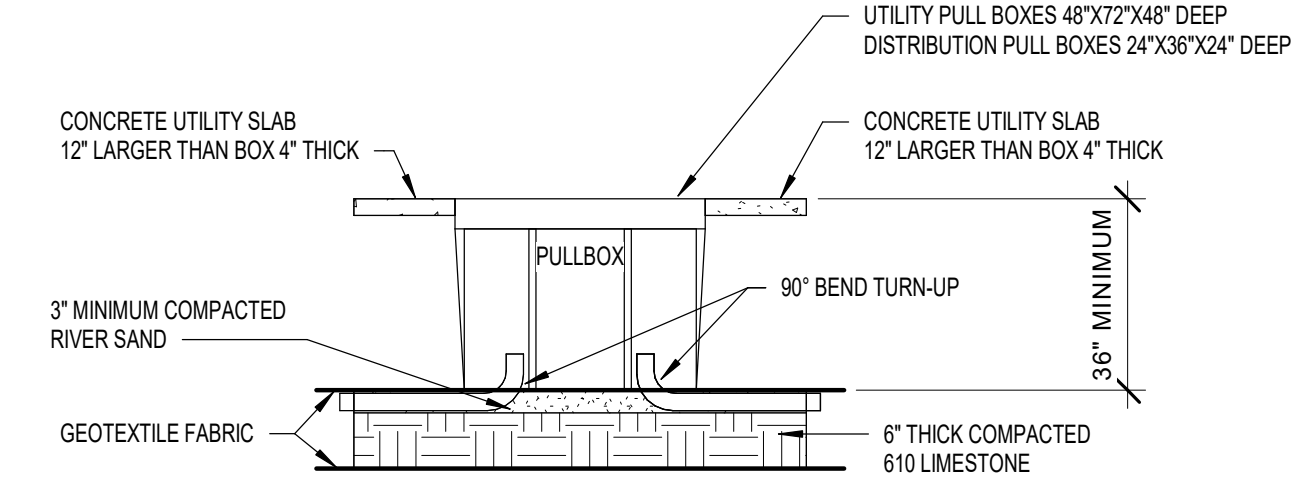

2 DETAIL - PULL BOX
N.T.S.

Branch Panel: LA																
Location:			Volts: 208Y/120			A.I.C. Rating: 22,000										
Supply From:			Phases: 3			Mains Rating: 200 A										
Mounting: SURFACE			Wires: 4			MCB Rating: 200 A										
Enclosure: NEMA-3R																
Number of Sections:																
Panel Schedule Notes: * - SEE SITE PLAN FOR CONDUIT AND WIRE SIZING. ** - FUTURE DEVICE. LOAD SHOWN IS ESTIMATED AND IS FOR REFERENCE ONLY.																
CKT	TRIP	POLES	WIRE	GND	CONDUIT	Circuit Description	A	B	C	Circuit Description	CONDUIT	GND	WIRE	POLES	TRIP	CKT
1	20 A	1	*	*	*	PARKING LOT LIGHTS	1.2 kVA	5.0 kVA								2
3						CHARGING STATION (DUAL STATION CKT. #1)		5.0 kVA	5.0 kVA							4
5	60 A	2	*	*	*	CHARGING STATION (DUAL STATION CKT. #1)			5.0 kVA	5.0 kVA						6
7	60 A	2	*	*	*	CHARGING STATION (DUAL STATION CKT. #2)	5.0 kVA	5.0 kVA								8
9						CHARGING STATION (SINGLE PEDESTAL)		5.0 kVA	5.0 kVA							10
11	20 A	1	*	*	*	PARKING LOT SIGNAGE**	1.5 kVA	0.0 kVA	1.5 kVA	5.0 kVA						12
13	20 A	1	*	*	*	PARKING LOT SIGNAGE**	1.5 kVA	0.0 kVA								14
15	20 A	1				SPARE			0.0 kVA	0.0 kVA						16
17	20 A	1				SPARE			0.0 kVA	0.0 kVA						18
19	20 A	1				SPARE	0.0 kVA	0.0 kVA								20
21	20 A	1				SPARE			0.0 kVA	0.0 kVA						22
23	20 A	1				SPARE			0.0 kVA	0.0 kVA						24
							17564 VA	19968 VA	16476 VA	0.0 kVA	0.0 kVA					
							148 A	168 A	137 A							
Load Classification		Connected Load		Demand Factor		Estimated Demand		Panel Totals								
Power		49920 VA		100.00%		49920 VA		Total Conn. Load: 54003 VA								
Lighting		4113 VA		125.00%		5142 VA		Total Est. Demand: 55024 VA								
								Total Conn.: 150 A								
								Total Est. Demand: 153 A								
Load Summary Notes:																

4-WIRE FEEDER SCHEDULE			
STD. FUSE OR BKR TRIP SIZE	# OF SETS	WIRE QUANTITY AND SIZE	CONDUIT SIZE (MINIMUM)
30	1	4#10 THWN, 1#10 GND	3/4"
60	1	4#6 THWN, 1#6 GND	1-1/4"
100	1	4#3 THWN, 1#6 GND	1-1/4"
125	1	4#1 THWN, 1#6 GND	1-1/2"
150	1	4#1/0 THWN, 1#6 GND	2"
200	1	4#3/0 THWN, 1#4 GND	2"
400	2	4#3/0 THWN, 1#3 GND	2-1/2"
600	2	4#350 THWN MCM, 1#1 GND	3"
800	3	4#300 THWN MCM, 1#1/0 GND	3"

NOTES:

- ALL FEEDER SIZES LISTED MAY NOT BE SHOWN IN POWER RISER DIAGRAM.
- ELECTRICAL CONTRACTOR TO VERIFY SIZE REQUIRED IF WIRE TYPES OTHER THAN THOSE LISTED ABOVE ARE USED.
- REFER TO THE LATEST EDITION OF THE NEC FOR CONDUIT TYPES REQUIRED PER THEIR TABLES.
- ALL CONDUCTORS TO BE COPPER.
- "VD" INDICATES WIRE UPSIZED FOR VOLTAGE DROP.
- "NG" INDICATES NO GROUNDING CONDUCTOR REQUIRED.

REVISIONS		NO.	BY	DATE	REMARKS
1	SPG	04/17/24			ADDENDUM #1

SHEET INFO		DRAWN	DTB	CHECKED	SPG	APPROVED	SPG	LAST EDIT	10/12/2023	PLOT DATE	10/12/2023	SUBMITTAL
------------	--	-------	-----	---------	-----	----------	-----	-----------	------------	-----------	------------	-----------

SITE PLAN
NEW DOWNTOWN SURFACE LOT - ST FERDINAND STREET
CITY OF BATON ROUGE - PARISH OF EAST BATON ROUGE
CITY PARISH PROJECT NO. 21-ASD-CP-1380

SCALE: AS SHOWN

PROJECT NUMBER: 2021-02
DRAWING FILE NAME: RISER DIAGRAM & SCHEDULES