



# MCNEESE STATE UNIVERSITY REQUEST FOR BID

LAKE CHARLES, LOUISIANA 70609

AN EQUAL OPPORTUNITY INSTITUTION

PHONE: (337) 475-5087

FAX: (337) 475-5082

DATE	BID NUMBER
05/21/24	L2500001

PURCHASING CONTACT	PHONE	REQUEST NO.	DEPARTMENT	VENDOR I.D. NO.
Kayla DeVillier	--	R2500012	Maintenance	000010313

SEE STANDARD TERMS & CONDITIONS TO BIDDERS.

VENDOR MUST SIGN AND RETURN BID FORM TITLED "STANDARD TERMS & CONDITIONS TO BIDDERS" WITH BID RESPONSE TO BE CONSIDERED FOR BID AWARD.

VENDOR:

Return this bid to McNeese State University  
 Purchasing Department, 150 Lawton Dr.,  
 Smith Hall room 120, Lake Charles, LA 70605  
 or MSU Box 92415, Lake Charles LA 70609

RESPONSE DUE 06/26/24 Bid due @ 2:00 PM

No.	Quantity	Description	Unit	Unit Price	Extension
		<p>Request for Sealed Bid (SB)</p> <p>*****            *****            THIS BID MUST BE RETURNED IN A SEALED ENVELOPE/            PACKAGE. PLEASE WRITE THE BID NUMBER            ON THE ENVELOPE/PACKAGE. RETURN TO ONE OF THE            ADDRESSES LISTED BELOW.            *****            Your sealed bid may be mailed or delivered by            hand or courier service.            -----            NOTE: FAX, EMAIL OR ANY OTHER ELECTRONIC            SUBMISSIONS ARE NOT ACCEPTABLE.            -----            *The address for mailing (U.S. Postal Service):            McNeese State University, Purchasing Department            Box 92415, Lake Charles, LA 70609</p>			

Bid must be signed below. I hereby certify that the above bid prices will remain in effect until the goods are delivered if the order is placed within 30 days after bid opening date. Validity of this bid is dependent on the following information:

Delivery \_\_\_\_\_ days ARO/TERMS \_\_\_\_\_

Phone ( ) \_\_\_\_\_

All bids include prepaid delivery, F.O.B. to McNeese State University

**THIS IS NOT A PURCHASE ORDER**

TOTAL

CONTINUED

Signature \_\_\_\_\_ Date \_\_\_\_\_



# MCNEESE STATE UNIVERSITY

LAKE CHARLES, LOUISIANA 70609

AN EQUAL OPPORTUNITY INSTITUTION

PHONE: (337) 475-5087

FAX: (337) 475-5082

# REQUEST FOR BID

DATE	BID NUMBER
05/21/24	L2500001

PURCHASING CONTACT	PHONE	REQUEST NO.	DEPARTMENT	VENDOR I.D. NO.
Kayla DeVillier	--	R2500012	Maintenance	000010313

**SEE STANDARD TERMS & CONDITIONS TO BIDDERS.**

**VENDOR MUST SIGN AND RETURN BID FORM TITLED "STANDARD TERMS & CONDITIONS TO BIDDERS" WITH BID RESPONSE TO BE CONSIDERED FOR BID AWARD.**

**VENDOR:**

Return this bid to McNeese State University  
 Purchasing Department, 150 Lawton Dr.,  
 Smith Hall room 120, Lake Charles, LA 70605  
 or MSU Box 92415, Lake Charles LA 70609

RESPONSE DUE 06/26/24 Bid due @ 2:00 PM

No.	Quantity	Description	Unit	Unit Price	Extension
1		<p>Request for Sealed Bid (SB)</p> <p>(Continued...)</p> <p>-----</p> <p>**The address for hand or courier service:            McNeese State University, Purchasing Department            150 Lawton Drive, Smith Hall Room 120            Lake Charles, LA 70609</p> <p>-----</p> <p>*Bidder is hereby advised that the U.S. Postal Service (USPS) does not make deliveries to the McNeese Purchasing Departments physical location. If delivering by USPS to the Box listed above, please allow sufficient time for the mail to then be transmitted to the McNeese Purchasing Department. The McNeese Purchasing Department must receive the sealed bid at its physical location by the date and time specified in this bid. Failure to meet the bid opening date and time shall result in rejection of the bid.</p> <p>**Bidder is solely responsible for ensuring that its courier service provider makes inside</p>			

Bid must be signed below. I hereby certify that the above bid prices will remain in effect until the goods are delivered if the order is placed within 30 days after bid opening date. Validity of this bid is dependent on the following information:

Delivery \_\_\_\_\_ days ARO/TERMS \_\_\_\_\_

Phone ( ) \_\_\_\_\_

All bids include prepaid delivery, F.O.B. to McNeese State University

**THIS IS NOT A PURCHASE ORDER**

TOTAL

CONTINUED

Signature \_\_\_\_\_ Date \_\_\_\_\_



# MCNEESE STATE UNIVERSITY REQUEST FOR BID

LAKE CHARLES, LOUISIANA 70609

AN EQUAL OPPORTUNITY INSTITUTION

PHONE: (337) 475-5087

FAX: (337) 475-5082

DATE	BID NUMBER
05/21/24	L2500001

PURCHASING CONTACT	PHONE	REQUEST NO.	DEPARTMENT	VENDOR I.D. NO.
Kayla DeVillier	--	R2500012	Maintenance	000010313

SEE STANDARD TERMS & CONDITIONS TO BIDDERS.

VENDOR MUST SIGN AND RETURN BID FORM TITLED "STANDARD TERMS & CONDITIONS TO BIDDERS" WITH BID RESPONSE TO BE CONSIDERED FOR BID AWARD.

**VENDOR:**

Return this bid to McNeese State University  
 Purchasing Department, 150 Lawton Dr.,  
 Smith Hall room 120, Lake Charles, LA 70605  
 or MSU Box 92415, Lake Charles LA 70609

RESPONSE DUE 06/26/24 Bid due @ 2:00 PM

No.	Quantity	Description	Unit	Unit Price	Extension
1		<p><b>Request for Sealed Bid (SB)</b></p> <p>(Continued...)            deliveries to the McNeese Purchasing Departments physical location. The McNeese Purchasing Department is not responsible for any delays caused by the Bidders chosen means means of delivery. Bidder is solely responsible for the timely delivery of its bid. Failure to meet the bid opening date and time shall result result in rejection of the bid.</p> <p>*****            A MANDATORY PRE-BID CONFERENCE AND SITE VISIT CONDUCTED BY MCNEESE WILL BE HELD ON WEDNESDAY, JUNE 19, 2024, AT 1:00 PM. ALL BIDDERS MUST ATTEND. LOCATION: 4406 COMMON STREET-MCNEESE FACILITIES OFFICE-LAKE CHARLES, LA 70607.</p> <p>-----            SEALED BID FOR CAMPUS WIDE GROUND MAINTENANCE AT MCNEESE AS PER THE ATTACHED SPECS AND MAPS (2). THIS BID IS FOR A 3-YEAR CONTRACT PERIOD: JULY 1, 2024, THROUGH JUNE 30, 2025. AT THE OPTION OF MCNEESE AND THE ACCEPTANCE BY THE CONTRACTOR,</p>			

Bid must be signed below. I hereby certify that the above bid prices will remain in effect until the goods are delivered if the order is placed within 30 days after bid opening date. Validity of this bid is dependent on the following information:

Delivery \_\_\_\_\_ days ARO/TERMS \_\_\_\_\_

Phone ( ) \_\_\_\_\_

All bids include prepaid delivery, F.O.B. to McNeese State University

**THIS IS NOT A PURCHASE ORDER**

TOTAL

CONTINUED

Signature \_\_\_\_\_ Date \_\_\_\_\_



# MCNEESE STATE UNIVERSITY

LAKE CHARLES, LOUISIANA 70609

AN EQUAL OPPORTUNITY INSTITUTION

PHONE: (337) 475-5087

FAX: (337) 475-5082

# REQUEST FOR BID

DATE	BID NUMBER
05/21/24	L2500001

PURCHASING CONTACT	PHONE	REQUEST NO.	DEPARTMENT	VENDOR I.D. NO.
Kayla DeVillier	--	R2500012	Maintenance	000010313

SEE STANDARD TERMS & CONDITIONS TO BIDDERS.

VENDOR MUST SIGN AND RETURN BID FORM TITLED "STANDARD TERMS & CONDITIONS TO BIDDERS" WITH BID RESPONSE TO BE CONSIDERED FOR BID AWARD.

**VENDOR:**

Return this bid to McNeese State University  
 Purchasing Department, 150 Lawton Dr.,  
 Smith Hall room 120, Lake Charles, LA 70605  
 or MSU Box 92415, Lake Charles LA 70609

RESPONSE DUE 06/26/24 Bid due @ 2:00 PM

No.	Quantity	Description	Unit	Unit Price	Extension
1		<p><b>Request for Sealed Bid (SB)</b></p> <p>(Continued...)</p> <p>THIS CONTRACT MAY BE RENEWED FOR TWO ADDITIONAL ONE-YEAR PERIODS UNDER THE ORIGINAL TERMS AND CONDITIONS.</p> <p>-----</p> <p>BOTH LANDSCAPE CONTRACTOR'S LICENSE AND HORTICULTURAL LICENSE/CERTIFICATE WILL BE REQUIRED CONTRACTOR MUST PROVIDE LICENSE NUMBERS BELOW.            LANDSCAPE CONTRACTOR LICENSE NO: _____            HORTICULTURAL LICENSE NO: _____</p> <p>-----</p> <p>SUCCESSFUL BIDDER WILL BE REQUIRED TO SUBMIT PROOF OF INSURANCE TO INCLUDE COMMERCIAL GENERAL LIABILITY, WORKER'S COMPENSATION AND AUTOMOBILE LIABILITY PRIOR TO COMMENCING WORK.</p> <p>-----</p> <p>NUMBER OF VISITS MAY BE MORE OR LESS DUE TO WEATHER CONDITIONS.</p> <p>-----</p> <p>INVOICES WILL BE SUBMITTED ON A MONTHLY BASIS WITH THE PER VISIT PRICING ITEMIZED AND DATE OF</p>			

Bid must be signed below. I hereby certify that the above bid prices will remain in effect until the goods are delivered if the order is placed within 30 days after bid opening date. Validity of this bid is dependent on the following information:

Delivery \_\_\_\_\_ days ARO/TERMS \_\_\_\_\_

Phone ( ) \_\_\_\_\_

All bids include prepaid delivery, F.O.B. to McNeese State University

**THIS IS NOT A PURCHASE ORDER**

TOTAL

CONTINUED

Signature \_\_\_\_\_ Date \_\_\_\_\_



# MCNEESE STATE UNIVERSITY REQUEST FOR BID

LAKE CHARLES, LOUISIANA 70609

AN EQUAL OPPORTUNITY INSTITUTION

PHONE: (337) 475-5087

FAX: (337) 475-5082

DATE	BID NUMBER
05/21/24	L2500001

PURCHASING CONTACT	PHONE	REQUEST NO.	DEPARTMENT	VENDOR I.D. NO.
Kayla DeVillier	--	R2500012	Maintenance	000010313

**SEE STANDARD TERMS & CONDITIONS TO BIDDERS.**

**VENDOR MUST SIGN AND RETURN BID FORM TITLED "STANDARD TERMS & CONDITIONS TO BIDDERS" WITH BID RESPONSE TO BE CONSIDERED FOR BID AWARD.**

**VENDOR:**

Return this bid to McNeese State University  
 Purchasing Department, 150 Lawton Dr.,  
 Smith Hall room 120, Lake Charles, LA 70605  
 or MSU Box 92415, Lake Charles LA 70609

RESPONSE DUE 06/26/24 Bid due @ 2:00 PM

No.	Quantity	Description	Unit	Unit Price	Extension
1		<p><b>Request for Sealed Bid (SB)</b></p> <p>(Continued...)            SERVICE. INVOICES MUST BE SENT TO FACILITIES BEFORE PAYMENT CAN BE MADE.</p> <p>-----            VENDOR MUST MEET WILBERT KELLY, THE GROUNDS MANAGER, AFTER EACH CUT TO SIGN A FORM BEFORE LEAVING CAMPUS.</p> <p>-----            ALL QUESTIONS AND INQUIRES MUST BE MADE IN WRITING TO: kdevillier@mcneese.edu BY FRIDAY, JUNE 21, 2024 AT 1:00 PM.            TWO MAPS OF CAMPUS ARE ASSOCIATED WITH THIS BID WHICH YOU FIND INCLUDED IN THE BID SPECIFICATIONS.</p>			
1	42	<p>PERFORM ALL SERVICES DESCRIBED HEREIN UNDER            MOWING, WEEDS, INSECTS, DISEASE, AND DEFICIENCIES, SAFETY, MOWING AND WEEDING SCHEDULE IN THE AREAS SHOWN ON THE MAP AS THE BASE BID.            SERVICES TO BE PROVIDED FOR A TOTAL OF APPROXIMATELY 42 VISITS PER YEAR</p>	EA		

Bid must be signed below. I hereby certify that the above bid prices will remain in effect until the goods are delivered if the order is placed within 30 days after bid opening date. Validity of this bid is dependent on the following information:

Delivery \_\_\_\_\_ days ARO/TERMS \_\_\_\_\_

Phone ( ) \_\_\_\_\_

All bids include prepaid delivery, F.O.B. to McNeese State University

**THIS IS NOT A PURCHASE ORDER**

TOTAL

CONTINUED

Signature \_\_\_\_\_ Date \_\_\_\_\_



# MCNEESE STATE UNIVERSITY REQUEST FOR BID

LAKE CHARLES, LOUISIANA 70609

AN EQUAL OPPORTUNITY INSTITUTION

PHONE: (337) 475-5087

FAX: (337) 475-5082

DATE	BID NUMBER
05/21/24	L2500001

PURCHASING CONTACT	PHONE	REQUEST NO.	DEPARTMENT	VENDOR I.D. NO.
Kayla DeVillier	--	R2500012	Maintenance	000010313

**SEE STANDARD TERMS & CONDITIONS TO BIDDERS.**

**VENDOR MUST SIGN AND RETURN BID FORM TITLED "STANDARD TERMS & CONDITIONS TO BIDDERS" WITH BID RESPONSE TO BE CONSIDERED FOR BID AWARD.**

**VENDOR:**

Return this bid to McNeese State University  
 Purchasing Department, 150 Lawton Dr.,  
 Smith Hall room 120, Lake Charles, LA 70605  
 or MSU Box 92415, Lake Charles LA 70609

RESPONSE DUE 06/26/24 Bid due @ 2:00 PM

No.	Quantity	Description	Unit	Unit Price	Extension
		<b>Request for Sealed Bid (SB)</b>			
1		(Continued...) (WEATHER PERMITTING) AS PER THE MOWING SCHEDULE INCLUDED IN THE BID SPECIFICATIONS SERVICES BEGINNING JULY1F THROUGH JUNE 30 YEARLY **DETAILED SPECIFICATIONS ATTACHED**			
2	42	ALTERNATE 1 - PROVIDE ALL SERVICES DESCRIBED IN THE BASE BID UNDER MOWING, WEEDS, INSECTS, DISEASE AND DEFICIENCIES, SAFETY, MOWING AND WEEDING SCHEDULE , IN AREAS SHOWN ON THE MAP AS ALTERNATE 1.	EA		
3	146	ALTERNATE 2 - PROVIDE ALL SERVICES DESCRIBED IN THE BASE BID UNDER MOWING, WEEDS, INSECTS, DISEASE AND DEFICIENCIES, SAFETY, MOWING, AND WEEDING SCHEDULE IN THE AREAS SHOWN ON THE MAP AS ALTERNATE 2. ON ATHLETIC SOCCER AND TRACK FIELDS TOTAL OF 146 MOWINGS PER YEAR AS FOLLOWS:	EA		

Bid must be signed below. I hereby certify that the above bid prices will remain in effect until the goods are delivered if the order is placed within 30 days after bid opening date. Validity of this bid is dependent on the following information:

Delivery \_\_\_\_\_ days ARO/TERMS \_\_\_\_\_

Phone ( ) \_\_\_\_\_

All bids include prepaid delivery, F.O.B. to McNeese State University

**THIS IS NOT A PURCHASE ORDER**

TOTAL

CONTINUED

Signature \_\_\_\_\_ Date \_\_\_\_\_



# MCNEESE STATE UNIVERSITY

LAKE CHARLES, LOUISIANA 70609

AN EQUAL OPPORTUNITY INSTITUTION

PHONE: (337) 475-5087

FAX: (337) 475-5082

# REQUEST FOR BID

DATE	BID NUMBER
05/21/24	L2500001

PURCHASING CONTACT	PHONE	REQUEST NO.	DEPARTMENT	VENDOR I.D. NO.
Kayla DeVillier	--	R2500012	Maintenance	000010313

**SEE STANDARD TERMS & CONDITIONS TO BIDDERS.**

**VENDOR MUST SIGN AND RETURN BID FORM TITLED "STANDARD TERMS & CONDITIONS TO BIDDERS" WITH BID RESPONSE TO BE CONSIDERED FOR BID AWARD.**

**VENDOR:**

Return this bid to McNeese State University  
 Purchasing Department, 150 Lawton Dr.,  
 Smith Hall room 120, Lake Charles, LA 70605  
 or MSU Box 92415, Lake Charles LA 70609

RESPONSE DUE 06/26/24 Bid due @ 2:00 PM

No.	Quantity	Description	Unit	Unit Price	Extension
		<b>Request for Sealed Bid (SB)</b>			
3		(Continued...) SOCCER FIELD WILL BE MOWED A TOTAL OF 66 TIMES PER YEAR (WEATHER PERMITTING). TRACK FIELD WILL BE MOWED A TOTAL OF 80 TIMES PER YEAR (WEATHER PERMITTING). **DETAILED INFORMATION INCLUDED IN THE ATTACHED BID SPECIFICATIONS**			
4	1	ADDITIONAL COST PER MAN HOUR TO PERFORM ADDITIONAL MULCHING IF REQUESTED IN DIFFERENT AREAS OF CAMPUS **MULCH WILL BE SUPPLIED BY MCNEESE**	EA		
5	1	ADDITIONAL COST PER MAN HOUR TO PERFORM ADDITION CUTTING AND/OR WEEDING IN AREAS OUTSIDE THE AREAS IDENTIFIED IN THE BASE BID OR ATLERNATE 1.	EA		
6	1	ALTERNATE 3 - PROVIDE WEED CONTROL (MANUAL AND SPRAYING) IN PAVED AREAS TO INCLUDE	EA		

Bid must be signed below. I hereby certify that the above bid prices will remain in effect until the goods are delivered if the order is placed within 30 days after bid opening date. Validity of this bid is dependent on the following information:

Delivery \_\_\_\_\_ days ARO/TERMS \_\_\_\_\_

Phone ( ) \_\_\_\_\_

All bids include prepaid delivery, F.O.B. to McNeese State University

**THIS IS NOT A PURCHASE ORDER**

TOTAL

CONTINUED

Signature \_\_\_\_\_ Date \_\_\_\_\_



# MCNEESE STATE UNIVERSITY REQUEST FOR BID

LAKE CHARLES, LOUISIANA 70609

AN EQUAL OPPORTUNITY INSTITUTION

PHONE: (337) 475-5087

FAX: (337) 475-5082

DATE	BID NUMBER
05/21/24	L2500001

PURCHASING CONTACT	PHONE	REQUEST NO.	DEPARTMENT	VENDOR I.D. NO.
Kayla DeVillier	--	R2500012	Maintenance	000010313

SEE STANDARD TERMS & CONDITIONS TO BIDDERS.

VENDOR MUST SIGN AND RETURN BID FORM TITLED "STANDARD TERMS & CONDITIONS TO BIDDERS" WITH BID RESPONSE TO BE CONSIDERED FOR BID AWARD.

VENDOR:

Return this bid to McNeese State University  
 Purchasing Department, 150 Lawton Dr.,  
 Smith Hall room 120, Lake Charles, LA 70605  
 or MSU Box 92415, Lake Charles LA 70609

RESPONSE DUE 06/26/24 Bid due @ 2:00 PM

No.	Quantity	Description	Unit	Unit Price	Extension
6		<p>Request for Sealed Bid (SB)</p> <p>(Continued...)</p> <p>COST OF WEED CONTROL HERBICIDES IN ALL AREAS</p> <p>TERMINATION FOR CONVENIENCE: MCNEESE MAY TERMINATE THIS AGREEMENT AT ANY TIME BY GIVING THIRTY (30) DAYS WRITTEN NOTICE TO CONTRACTOR OF SUCH TERMINATION OR NEGOTIATING WITH THE CONTRACTOR AN EFFECTIVE DATE.</p> <p>TERMINATION FOR CAUSE: MCNEESE MAY TERMINATE THIS AGREEMENT FOR CAUSE BASED UPON THE FAILURE OF CONTRACTOR TO COMPLY WITH THE TERMS AND/OR CONDITIONS OF THE AGREEMENT PROVIDED THAT MCNEESE SHALL GIVE THE CONTRACTOR WRITTEN NOTICE SPECIFYING THE CONTRACTOR'S FAILURE. IF WITHIN THIRTY (30) DAYS AFTER RECEIPT OF SUCH NOTICE, THE CONTRACTOR SHALL NOT HAVE CORRECTED SUCH FAILURE OR, IN THE CASE OF FAILURE WHICH CANNOT BE CORRECTED IN (30) DAYS, BEGUN IN GOOD FAITH TO CORRECT SUCH FAILURE AND THEREAFTER PROCEEDED DILIGENTLY TO COMPLETE SUCH CORRECTION, THEN MCNEESE MAY, AT ITS OPTION, PLACE THE CONTRACTOR IN DEFAULT AND THE AGREEMENT SHALL TERMINATE ON</p>			

Bid must be signed below. I hereby certify that the above bid prices will remain in effect until the goods are delivered if the order is placed within 30 days after bid opening date. Validity of this bid is dependent on the following information:

Delivery \_\_\_\_\_ days ARO/TERMS \_\_\_\_\_

Phone ( ) \_\_\_\_\_

All bids include prepaid delivery, F.O.B. to McNeese State University

**THIS IS NOT A PURCHASE ORDER**

TOTAL

CONTINUED

Signature \_\_\_\_\_ Date \_\_\_\_\_





# MCNEESE STATE UNIVERSITY REQUEST FOR BID

LAKE CHARLES, LOUISIANA 70609

AN EQUAL OPPORTUNITY INSTITUTION

PHONE: (337) 475-5087

FAX: (337) 475-5082

DATE	BID NUMBER
05/21/24	L2500001

PURCHASING CONTACT	PHONE	REQUEST NO.	DEPARTMENT	VENDOR I.D. NO.
Kayla DeVillier	--	R2500012	Maintenance	000010313

**SEE STANDARD TERMS & CONDITIONS TO BIDDERS.**

**VENDOR MUST SIGN AND RETURN BID FORM TITLED "STANDARD TERMS & CONDITIONS TO BIDDERS" WITH BID RESPONSE TO BE CONSIDERED FOR BID AWARD.**

**VENDOR:**

Return this bid to McNeese State University  
 Purchasing Department, 150 Lawton Dr.,  
 Smith Hall room 120, Lake Charles, LA 70605  
 or MSU Box 92415, Lake Charles LA 70609

RESPONSE DUE 06/26/24 Bid due @ 2:00 PM

No.	Quantity	Description	Unit	Unit Price	Extension
6		<p><b>Request for Sealed Bid (SB)</b></p> <p>(Continued...)</p> <p>THE DATE SPECIFIED IN SUCH NOTICE.            THE CONTRACTOR MAY EXERCISE ANY RIGHTS AVAILABLE TO IT UNDER LOUISIANA LAW TO TERMINATE FOR CAUSE UPON THE FAILURE OF MCNEESE TO COMPLY WITH THE TERMS AND CONDITIONS OF THIS AGREEMENT, PROVIDED THAT THE CONTRACTOR SHALL GIVE MCNEESE WRITTEN NOTICE SPECIFYING MCNEESE'S FAILURE AND A REASONABLE OPPORTUNITY FOR MCNEESE TO CURE THE DEFECT.</p> <p>A CURRENT CERTIFICATE OF INSURANCE MUST BE PROVIDED AND SUBMITTED PRIOR TO COMMENCING WORK. CERTIFICATES PROVIDED SHALL INCLUDE MCNEESE STATE UNIVERSITY AS AN ADDITIONAL INSURED AS REGARDS THE SOLE NEGLIGENCE OF THE CONTRACTOR.</p> <p>•            PROVIDE A CERTIFICATE OF LIABILITY INSURANCE PRIOR TO WORKING ON CAMPUS AS FOLLOWS:            1. COMMERCIAL GENERAL LIABILITY: \$1,000,000 COMBINED SINGLE LIMIT PER OCCURRENCE FOR BODILY INJURY, PERSONAL INJURY AND PROPERTY DAMAGE AND</p>			

Bid must be signed below. I hereby certify that the above bid prices will remain in effect until the goods are delivered if the order is placed within 30 days after bid opening date. Validity of this bid is dependent on the following information:

Delivery \_\_\_\_\_ days ARO/TERMS \_\_\_\_\_

Phone ( ) \_\_\_\_\_

All bids include prepaid delivery, F.O.B. to McNeese State University

**THIS IS NOT A PURCHASE ORDER**

TOTAL

CONTINUED

Signature \_\_\_\_\_ Date \_\_\_\_\_



# MCNEESE STATE UNIVERSITY

LAKE CHARLES, LOUISIANA 70609

AN EQUAL OPPORTUNITY INSTITUTION

PHONE: (337) 475-5087

FAX: (337) 475-5082

# REQUEST FOR BID

DATE	BID NUMBER
05/21/24	L2500001

PURCHASING CONTACT	PHONE	REQUEST NO.	DEPARTMENT	VENDOR I.D. NO.
Kayla DeVillier	--	R2500012	Maintenance	000010313

SEE STANDARD TERMS & CONDITIONS TO BIDDERS.

VENDOR MUST SIGN AND RETURN BID FORM TITLED "STANDARD TERMS & CONDITIONS TO BIDDERS" WITH BID RESPONSE TO BE CONSIDERED FOR BID AWARD.

**VENDOR:**

Return this bid to McNeese State University  
 Purchasing Department, 150 Lawton Dr.,  
 Smith Hall room 120, Lake Charles, LA 70605  
 or MSU Box 92415, Lake Charles LA 70609

RESPONSE DUE 06/26/24 Bid due @ 2:00 PM

No.	Quantity	Description	Unit	Unit Price	Extension
6		<p><b>Request for Sealed Bid (SB)</b></p> <p>(Continued...)</p> <p>A MINIMUM GENERAL AGGREGATE OF \$2,000,000</p> <p>2. AUTOMOBILE LIABILITY: \$1,000,000 COMBINED SINGLE LIMIT PER ACCIDENT FOR BODILY INJURY AND PROPERTY DAMAGE.</p> <p>3. WORKMAN'S COMPENSATION AND EMPLOYERS LIABILITY WORKERS' COMPENSATION LIMITS AS REQUIRED BY THE LABOR CODE OF THE STATE OF LOUISIANA AND EMPLOYERS LIABILITY COVERAGE.</p> <p>.</p> <p><b>**WORKERS COMPENSATION INDEMNITY**</b></p> <p>IN THE EVENT CONTRACTOR IS NOT REQUIRED TO PROVIDE OR ELECTS NOT TO PROVIDE WORKERS COMPENSATION COVERAGE, THE PARTIES HEREBY AGREE THAT CONTRACTOR, ITS OWNERS, AGENTS AND EMPLOYEES WILL HAVE NO CAUSE OF ACTION AGAINST, AND WILL NOT ASSERT A CLAIM AGAINST, THE STATE OF LOUISIANA, ITS DEPARTMENTS, AGENCIES, AGENTS AND EMPLOYEES AS AN EMPLOYER, WHETHER PURSUANT TO THE LOUISIANA WORKERS COMPENSATION ACT OR OTHERWISE, UNDER ANY CIRCUMSTANCE. THE PARTIES ALSO HEREBY AGREE</p>			

Bid must be signed below. I hereby certify that the above bid prices will remain in effect until the goods are delivered if the order is placed within 30 days after bid opening date. Validity of this bid is dependent on the following information:

Delivery \_\_\_\_\_ days ARO/TERMS \_\_\_\_\_

Phone ( ) \_\_\_\_\_

All bids include prepaid delivery, F.O.B. to McNeese State University

**THIS IS NOT A PURCHASE ORDER**

TOTAL

CONTINUED

Signature \_\_\_\_\_ Date \_\_\_\_\_



**MCNEESE STATE UNIVERSITY**  
**LAKE CHARLES, LOUISIANA 70609**

AN EQUAL OPPORTUNITY INSTITUTION  
 PHONE: (337) 475-5087  
 FAX: (337) 475-5082

**REQUEST FOR BID**

DATE	BID NUMBER
05/21/24	L2500001

PURCHASING CONTACT	PHONE	REQUEST NO.	DEPARTMENT	VENDOR I.D. NO.
Kayla DeVillier	--	R2500012	Maintenance	000010313

SEE STANDARD TERMS & CONDITIONS TO BIDDERS.  
VENDOR MUST SIGN AND RETURN BID FORM TITLED "STANDARD TERMS & CONDITIONS TO BIDDERS" WITH BID RESPONSE TO BE CONSIDERED FOR BID AWARD.

**VENDOR:**

Return this bid to McNeese State University  
 Purchasing Department, 150 Lawton Dr.,  
 Smith Hall room 120, Lake Charles, LA 70605  
 or MSU Box 92415, Lake Charles LA 70609

RESPONSE DUE 06/26/24 Bid due @ 2:00 PM

No.	Quantity	Description	Unit	Unit Price	Extension
6		<p><b>Request for Sealed Bid (SB)</b></p> <p>(Continued...)            THAT THE STATE OF LOUISIANA, ITS DEPARTMENTS, AGENCIES, AGENTS AND EMPLOYEES SHALL IN NO CIRCUMSTANCE BE, OR CONSIDERED AS, THE EMPLOYER OR STATUTORY EMPLOYER OF CONTRACTOR, ITS OWNERS, AGENTS AND EMPLOYEES. THE PARTIES FURTHER AGREE THAT CONTRACTOR IS A WHOLLY INDEPENDENT CONTRACTOR AND IS EXCLUSIVELY RESPONSIBLE FOR ITS EMPLOYEES, OWNERS, AND AGENTS. CONTRACTOR HEREBY AGREES TO PROTECT, DEFEND, INDEMNIFY AND HOLD THE STATE OF LOUISIANA, ITS DEPARTMENTS, AGENCIES AND EMPLOYEES HARMLESS FROM ANY SUCH ASSERTION OR CLAIM THAT MAY ARISE FROM THE PERFORMANCE OF THIS CONTRACT.</p>			

Bid must be signed below. I hereby certify that the above bid prices will remain in effect until the goods are delivered if the order is placed within 30 days after bid opening date. Validity of this bid is dependent on the following information:

Delivery \_\_\_\_\_ days ARO/TERMS \_\_\_\_\_

Phone ( ) \_\_\_\_\_

All bids include prepaid delivery, F.O.B. to McNeese State University

**THIS IS NOT A PURCHASE ORDER**

TOTAL

Signature \_\_\_\_\_ Date \_\_\_\_\_

**STANDARD TERMS & CONDITIONS TO BIDDERS**  
**FAX #337-475-5082**

**PROPOSALS:** The proposal must be received by the Purchasing Department, McNeese State University, before the time set for receiving bids. Bids received after the time set will not be considered. Bidder shall assume full responsibility for timely delivery at location designated for receipt of bids. Prices must be clear and be written in ink or typewritten, and the ITB AND Terms & Conditions must be signed in ink. Be sure bid number and due date are clearly shown on outside of package or envelope. Please see return address on the face of the bid form.

**STANDARDS OF QUALITY AND ANY ALTERNATE:** Any product or service bid shall conform to all applicable Federal and State Laws and Regulations and the specifications contained in the solicitation. Unless otherwise specified in the solicitation, any manufacturer's name, trade name, brand name, or catalog number used in the specification is for the purpose of describing the standard of quality, performance, and characteristics desired and is not intended to limit or restrict competition. Bidder must specify the brand and model number of the product offered in his bid. Bids not specifying brand and model number shall be considered as offering the exact products specified in the solicitation.

When a Pre-Bid Conference is scheduled, no alternative will be considered unless the above conditions are complied with and the "Request for Approval of Alternate" form is completed and returned. This form will be attached when applicable. Only alternates which are approved and acknowledged by addendum following the Pre-Bid Conference will be considered for award at the bid opening. DO NOT SUBMIT BIDS ON UNAPPROVED ALTERNATES.

The burden of proof of the merit of the proposed substitute is upon the proposer. The Purchasing Director's decision of approval or rejection of a proposed substitute shall be final.

**SAMPLES/DESCRIPTIVE LITERATURE:** The envelope/package containing samples and/or descriptive literature submitted by mail for consideration at the Pre-Bid Conference must be labeled in accordance with the instructions given on the "Request for Approval of Alternate" form.

When requested, samples submitted will be returned at bidder's risk and expense provided they have not been made useless through tests.

**PRICES:** Unless otherwise specified by McNeese in the solicitation, bid prices must be complete, including transportation prepaid by bidder to destination and firm for acceptance for a minimum of 30 days. If accepted, prices must be firm for the contractual period. Bids other than F.O.B. destination may be rejected. Prices should be quoted in the unit (each, box, case, etc.) as specified in the solicitation.

**BID OPENING:** Bidders may attend the bid opening, but no information or opinions concerning the ultimate contract award will be given at the bid opening or during the evaluation process. Bids may be examined within 72 hours after bid opening. Information pertaining to completed files may be secured by visiting McNeese during normal working hours. Written bid tabulations will not be furnished.

**AWARD OF BIDS:** McNeese State University reserves the right to award items separately, grouped, or on an all-or-none basis, and to reject any or all bids and waive any informalities incident thereto.

**DELIVERY FAILURE:** If the vendor fails to make delivery within the time specified on bid documents or within a reasonable time if no delivery time is specified McNeese reserves the right to cancel the item and to purchase it elsewhere. Any increase in price and/or cost of handling will be charged to the vendor making the original unsatisfactory delivery. Consistent unsatisfactory deliveries will be considered just cause for deleting a vendor from bid lists.

**TERMINATION OF THIS AGREEMENT FOR CAUSE/CONVENIENCE:** McNeese may terminate this agreement for cause based upon the failure of Contractor to comply with the terms and/or conditions of the Agreement, or failure to fulfill its performance obligations pursuant to this agreement, provided that McNeese shall give the Contractor written notice specifying the Contractor's failure. If within thirty (30) days after receipt of such notice, the Contractor shall not have corrected such failure or, in the case of failure which cannot be corrected in thirty (30) days, begun in good faith to correct such failure and thereafter proceeded diligently to complete such correction, then McNeese may, at its option, place the Contractor in default and the Agreement shall terminate on the date specified in such notice.

The Contractor may exercise any rights available to it under Louisiana law to terminate for cause upon the failure of McNeese to comply with the terms and conditions of this agreement, provided the Contractor shall give McNeese written notice specifying McNeese's failure and a reasonable opportunity for McNeese to cure the defect.

McNeese may terminate the Contract at any time by giving thirty (30) days written notice to the Contractor of such termination or negotiating with the Contractor an effective date.

**SOLICITATIONS FOR (MOST) GOODS, NOT SERVICES, INCLUDE THE LOUISIANA PRODUCT PREFERENCE AS STATED BELOW:**

IN ACCORDANCE WITH LOUISIANA REVISED STATUTES 39:1604, A PREFERENCE MAY BE ALLOWED FOR PRODUCTS MANUFACTURED, PRODUCED, GROWN, OR ASSEMBLED IN LOUISIANA OF EQUAL QUALITY.

PREFERENCES SHALL NOT APPLY TO SERVICE CONTRACTS.

Do you claim this Preference? YES \_\_\_\_\_ NO \_\_\_\_\_

Specify Line Number(s): \_\_\_\_\_

Specify location within Louisiana where this product is manufactured, produced, grown or assembled: \_\_\_\_\_  
(NOTE): If more space is required, include on separate sheet.)

Do you have a Louisiana business workforce? YES \_\_\_\_\_ NO \_\_\_\_\_

If so, do you certify that at least fifty percent (50%) of your Louisiana business workforce is comprised of Louisiana residents? YES \_\_\_\_\_ NO \_\_\_\_\_

**IN ACCORDANCE WITH L.R.S. 39:1594 (ACT 121), THE PERSON SIGNING THE BID MUST BE:**

1. A current corporate officer, partnership member or other individual specifically authorized to submit a bid as reflected in the appropriate records on file with the Secretary of State; or
2. An individual authorized to bind the vendor as reflected by a corporate resolution, certificate or affidavit; or
3. Other documents indicating authority which are acceptable to the public entity.

By signing and returning this document (along with bid), you are certifying compliance with all Terms and Conditions set forth.

\_\_\_\_\_  
Signature & Company Name

\_\_\_\_\_  
Date

# McNeese State University Grounds Maintenance

## BASE BID

Perform all services described herein under **Mowing, Weeds, Insects, Disease, and Deficiencies, Safety, Mowing and Weeding Schedule**, in the areas shown on the map as the **Base Bid**.

## Mowing

- Mowing shall be performed weekly throughout the growing season to maintain a height between 1"-2". If weather or growth rate force the turf to grower quicker, mowing operations will be adjusted in order to observe the culturally accepted rule of not removing more than 1/3 of the total leaf surface when mowing. During the off season mowing will be performed less frequently but shall meet the 1"-2"" height standard. Contractor shall properly inspect the areas to be cut to assure they are not overly wet and thereby causing excessive rutting. If the Contractor feels the areas are excessively wet to properly cut they will notify the University's designated representative to convey their concerns. Only the University's designated representative has the authority to waive the need to cut the grass weekly or as indicated in the schedule provided herein. **If a scheduled cutting is missed the monthly contract invoicing will be reduced accordingly.**
- All mowers will have mulching capabilities. Blades will be maintained sharp and properly balanced. Mowers shall be maintained so as to not leak any fluids of any type on grass or other hard surfaces. Should this happen all damage will be the responsibility of the Contractor to make repairs, including the replacement of turf, power washing hard surfaces, etc. Broken down equipment must be removed from the site immediately and cannot be kept on campus overnight. All mowers shall have discharge guards and be left in the down position at all times when mower is running and in the vicinity of the campus population.
- Prior to the commencement of each mowing operation, the site will be inspected for debris and potential hazards. All debris, including tree limbs, paper, etc., will be removed from the site prior to the commencement of mowing. If debris is inadvertently mowed, all the aftereffects will be removed.
- Clippings will be mulched, dispersed, blown or removed after mowing. All clippings shall be kept out of ornamental beds and off of paved areas, courts and patio areas. The discharge should face away from beds.
- Edging of Hard Surfaces (curbs, sidewalks and hard-edged beds) shall be performed to a neat, crisp edge every other mowing cycle minimum or as needed to ensure a reasonable acceptable appearance. Edgers will be maintained in

proper working order to complete the task at hand. Break downs should be minimal and additional equipment should be available to complete the job. Metal edging shall be repaired/replace if it gets broke or damaged.

- All hard surfaces shall be immediately blown to maintain a clean, well groomed appearance.
- All areas inaccessible to mowers shall be string trimmed at the same height as the mowed areas and with the same frequency. Areas inaccessible to mowing equipment such as banks, hills, inside guard rails /fencing around meters, against any and all vertical surfaces and under trees, hedges and shrub rows will be performed with the same frequency of mowing. Contractor shall take proper care to not damage surfaces of buildings, signs, plant life, parked and moving cars, etc. during trimming operations. It is expected that all weeds are cut down at each mowing in all areas shown on the attached maps
- Invasive or creeping/climbing weeds are to be removed from buildings/fences/trees/etc.
- All areas littered in the landscape maintenance process will be removed by hand and disposed of or when appropriate, blown free of debris.
- There are various types of grass on the McNeese Campus with the predominate grasses being St. Augustine, Common Bermuda and Zoysia. Mowing will be done with the correct type mower/blades to properly maintain the health and visual appearance of each type of grass.
- The contractor will work with the Owners representative regarding the scheduling of mowing and trimming activities. During months when 4 visits are designated it is expected that the entire campus as designated on the attached map will be completely cut and trimmed unless specified otherwise due to scheduled events. The McNeese Campus is an extremely active community and as such the schedule must be flexible to work with the various events that occur throughout the campus.

### **Weeds, Insects, Disease, and Deficiencies**

- Visual inspections will be conducted while performing maintenance practices.
- Identification of pests will be reported to McNeese State.
- Detection of Diseases, Insects, Weeds and other Deficiencies will be reported.

### **Safety**

- All operators will use Personal Protective Equipment according to the task being performed. (Safety Glasses, Hearing protection, long pants, work boots, reflective vest, gloves etc.).
- Operators shall wear uniform shirts clearly identifying each as an employee of the Contractor and said identification will not be covered by safety vest , jackets, sweaters etc. unless those too have some means of identification of the Contractor/Company.
- Operators shall use the best decorum while on the Campus.

### **Mowing and Weeding Schedule**

- January – 2 visits
- February- 2 visits
- March- 4 visits
- April – 4 visits
- May – 4 visits
- June- 4 visits
- July- 4 visits
- August- 4 visits
- September- 4 visits
- October- 4 visits
- November – 4 visits
- December – 2 visits

**TOTAL NUMBER OF VISITS = 42 PER CONTRACT YEAR – JULY 1 – JUNE 30**

### **Bed Maintenance in Quad and John McNeese Park**

- Visual inspection of necessary bed maintenance should be performed per the mowing schedule set up in the base bid, and all weeds removed in all beds every week.
- Any shrubs obstructing pedestrian traffic, patios and walkways will be pruned as needed not to encroach over these paths however no pruning will take place if plants have already formed buds, and just before blooming.
- Hedges being sheared will maintain the shape as found or to a narrow top than base.
- Shrubs will be selectively pruned to remove excess growth and disease or insect damage.
- Beds shall be kept free of weeds through manual removal or the proper use of pre and post emergent herbicides without harming surrounding shrubs, flowers, ornamental trees and/or live oaks, etc.

- All Local, State and Federal regulations that govern the handling, application and storage of pesticides, herbicides and fertilizers shall be adhered to.
- All debris from shrub maintenance and bed weeding will be promptly removed off site.

## **Mulch**

- Pine Bark Mulch supplied by McNeese State will be installed according to directions from University designated representative, around trees, shrubs and flowers in the quad and John McNeese Park. Pine Bark Mulch may be supplied in bulk or bags and staged in the vicinity of the work.
- Contractor will be responsible for moving Pine Bark mulch to individual areas and the proper spreading to a depth not to exceed 2” maximum in one season unless told otherwise.
- All areas littered in the process of mulching shall be picked up or blown free of debris.
- Mulching will be done 2 times per year.

## **Alternate 1**

- Provide all services described in the BASE BID under **Mowing, Weeds, Insects, Disease, and Deficiencies, Safety, Mowing and Weeding Schedule**, in areas shown on the map as **Alternate 1**

## **Alternate 2**

- Provide all services described in the BASE BID under **Mowing, Weeds, Insects, Disease, and Deficiencies, Safety, Mowing and Weeding Schedule**, in areas shown on the map as **Alternate 2**

## **Line Item Cost for Additional Services**

- Please provide additional cost per man hour to perform additional mulching (Pine Bark mulch supplied by McNeese) if requested in other areas of the campus.
- Please provide additional cost per man hour to perform additional weed control (spraying) in paved areas to include cost of weed control herbicides.
- Please provide additional cost per man hour to perform additional cutting in areas outside the areas identified in the base bid or alternates 1 and 2.



**The successful contractor will be required to sign in and out with the Grounds Superintendent, who will then sign off stating that all work was completed. This will be used to verify pay applications monthly.**

**ALL PROSPECTIVE BIDDERS SHALL VISIT THE SITE OF REQUIRED WORK AND SHALL FULLY AQUAINT THEMSELVES WITH RELATED CONDITIONS SO THEY MAY FULLY UNDERSTAND THE FACILITIES DIFFICULTIES AND ANY RESTRICTIONS PERTAINING TO THE EXECUTION OF THE WORK OF THIS CONTRACT. WHILE THE PLANS IN GENERAL SHOW A GREAT BIT OF DETAIL, IN SOME INSTANCES THEY DO NOT SHOW ALL SIDEWALKS, BUILDING OFFSETS, ETC. HOWEVER, THE CONTRACTOR IS RESPONSIBLE FOR FULLFILLING ALL ASPECTS AND INTENT OF THE CONTRACT AS IF ALL DETAIL IS SHOWN ON THE PLANS.**

**REPRESENTATIVES FROM MCNEESE FACILITIES AND PLANNING WILL CONDUCT THE VISIT. THE SITE VISIT FORM INCLUDED IN THIS BID SHOULD BE FILLED OUT AND SIGNED BY BOTH THE CONTRACTOR AND THE UNIVERSITY REPRESENTATIVE AND RETURNED WITH THE BID.**

**The contract will be for 3years with the ability to renew for 2 additional one year periods.**

# Exclude Housing Blocks

Bed Maintenance  
Included in Base Bid  
Campus Quad &  
John McNeese Park

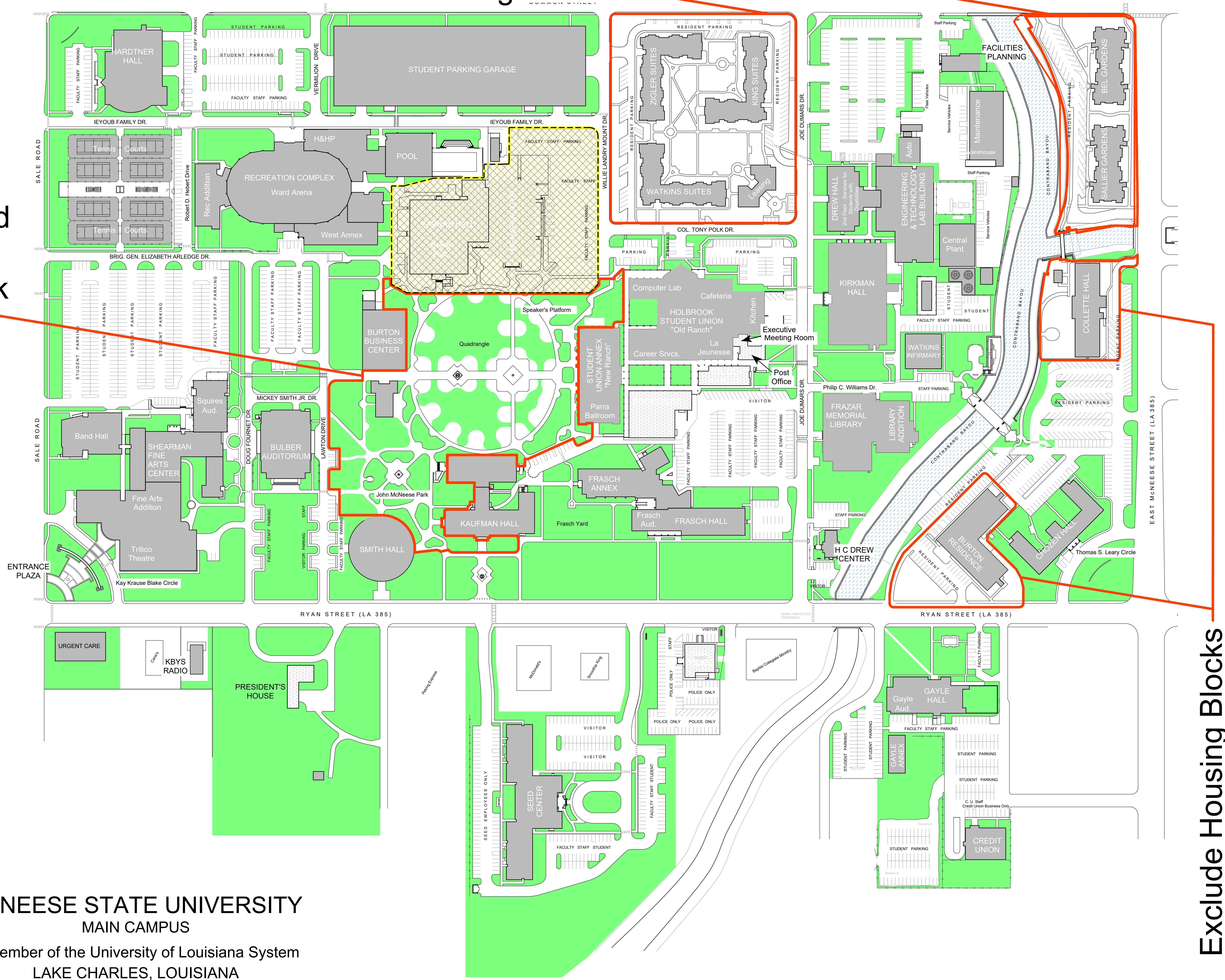

GENERAL NOTES:  
ALL BIDDERS SHALL VISIT THE SITE OF REQUIRED WORK AND SHALL FULLY ACQUAINT THEMSELVES WITH THE RELATED CONDITIONS SO THEY MAY UNDERSTAND THE FACILITY'S DIFFICULTIES AND ANY RESTRICTIONS PERTAINING TO THE EXECUTION OF THE WORK IN THIS CONTRACT. APPOINTMENTS SHALL BE ARRANGED WITH FACILITIES AND PLANT OPERATIONS, 337-475-5887.

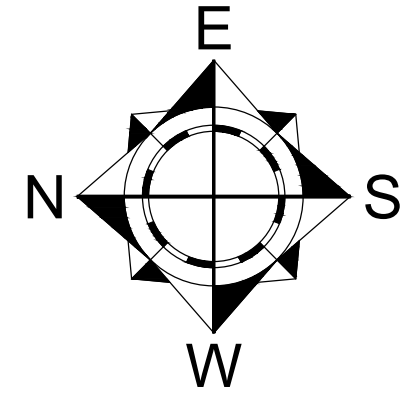

**McNEESE STATE UNIVERSITY**  
MAIN CAMPUS  
A Member of the University of Louisiana System  
LAKE CHARLES, LOUISIANA

Spring 2024

Exclude Housing Blocks

**ALTERNATE #2**  
**Soccer Field**  
**Reel Mower**  
**Required**

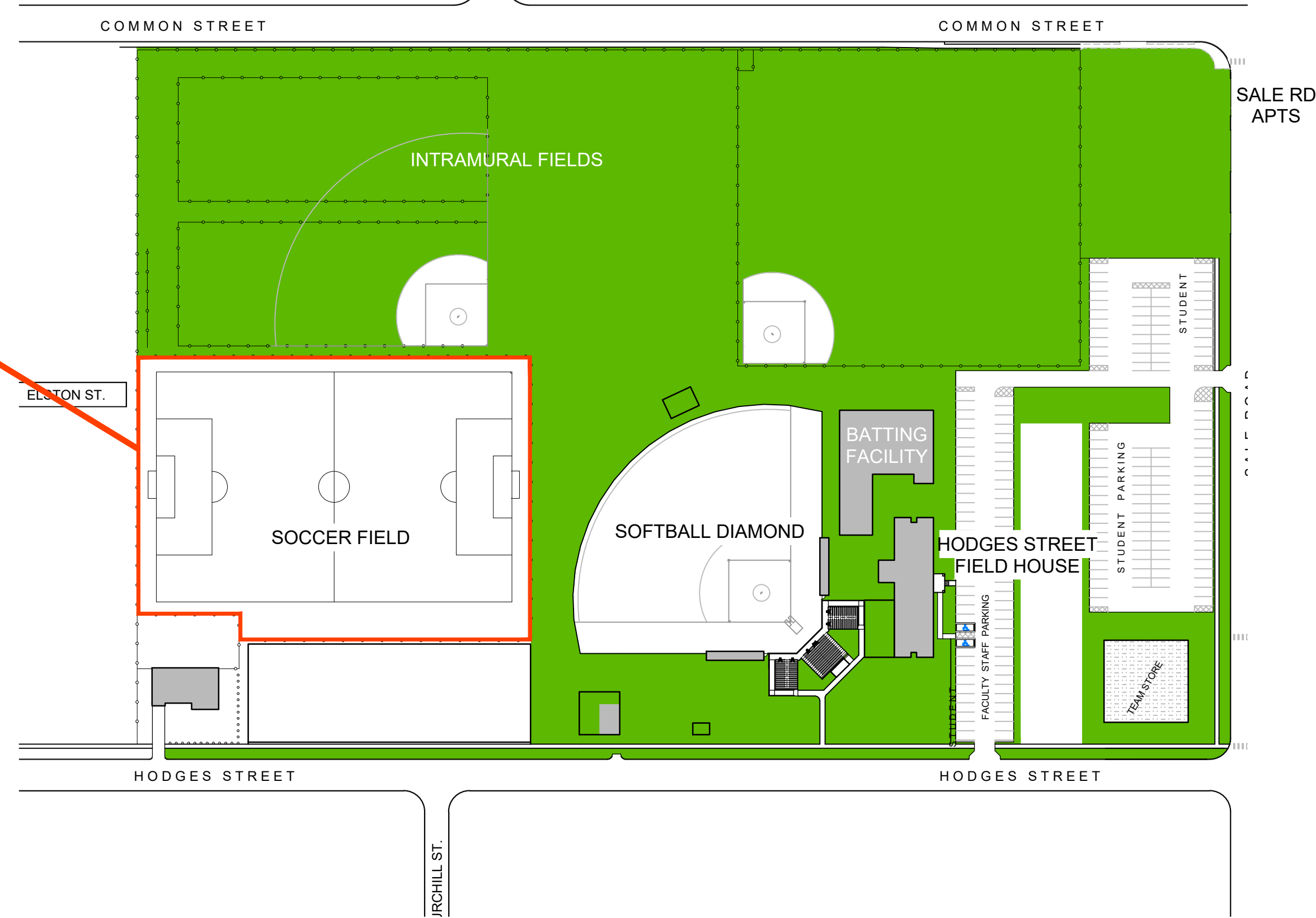

**ALTERNATE #1**  
**North Campus**

GENERAL NOTES:  
 ALL BIDDERS SHALL VISIT THE SITE OF REQUIRED WORK AND SHALL FULLY ACQUAINT THEMSELVES WITH THE RELATED CONDITIONS SO THEY MAY UNDERSTAND THE FACILITY'S DIFFICULTIES AND ANY RESTRICTIONS PERTAINING TO THE EXECUTION OF THE WORK IN THIS CONTRACT. APPOINTMENTS SHALL BE ARRANGED WITH FACILITIES AND PLANT OPERATIONS, 337-475-5887.

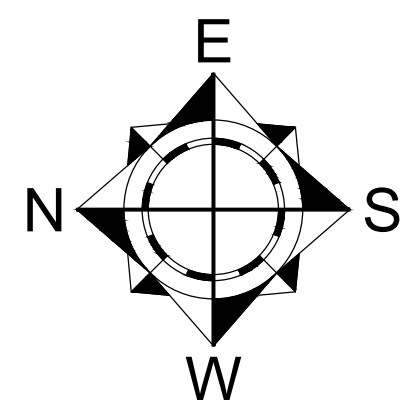

**McNEESE STATE UNIVERSITY**  
 NORTH AND ATHLETIC CAMPUSES  
 A Member of the University of Louisiana System  
 LAKE CHARLES, LOUISIANA

Spring 2024

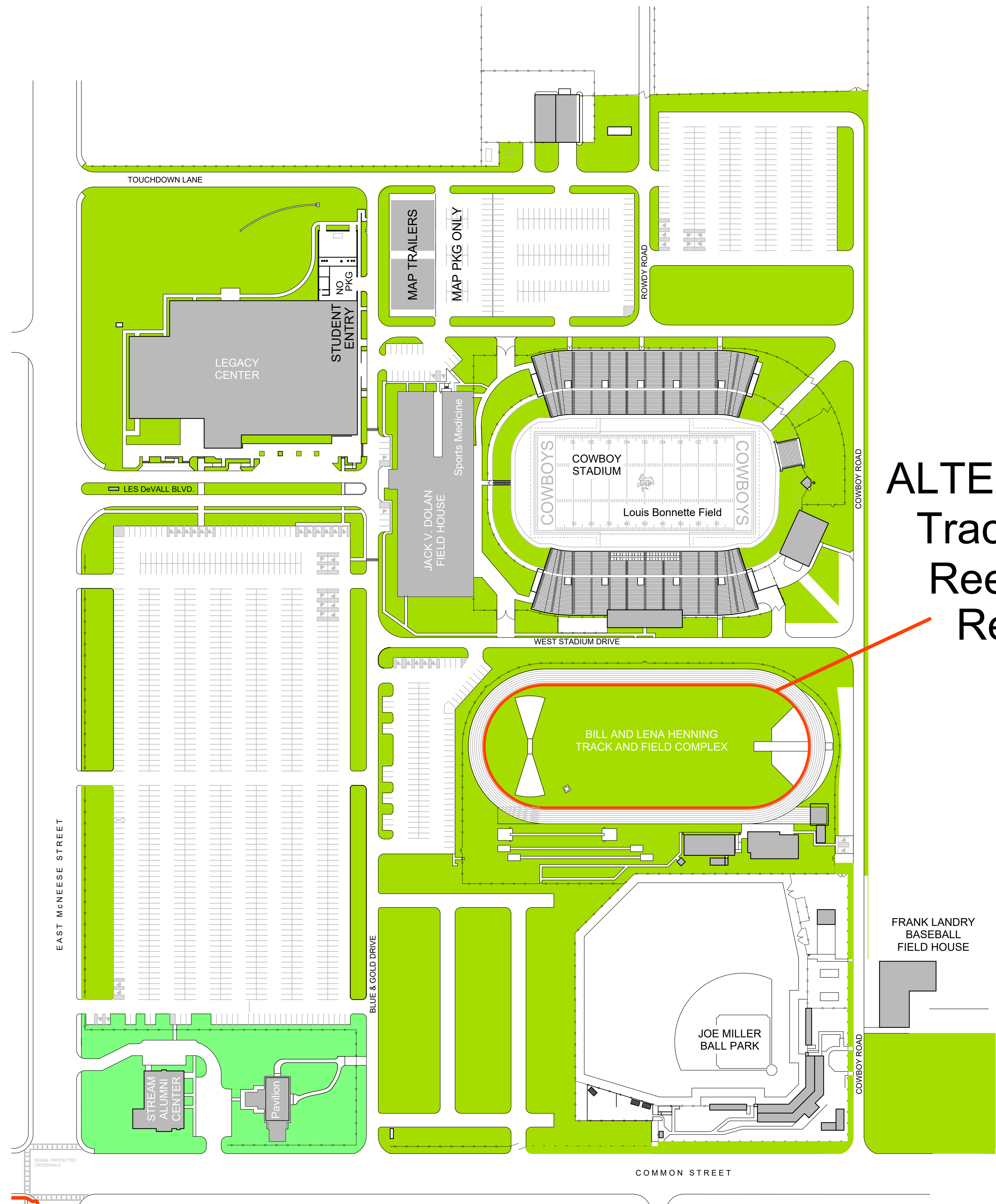

**ALTERNATE #2**  
**Track Interior**  
**Reel Mower**  
**Required**

**Included in Base Bid**  
**Athletic Campus**