

EXHIBIT B

**NAOMI OUTFALL (BAYOU DUPONT & GOOSE BAYOU) PROJECT
(BA-0003c)**



Naomi Outfall Management (BA-03c)

Project Status

Approved Date: 1996 **Project Area:** 26,603 acres

Approved Funds: \$2.30 M **Total Est. Cost:** \$2.30 M

Net Benefit After 20 Years: 633 acres

Status: Completed Aug. 2002

Project Type: Outfall Management

PPL #: 5

Location

The project features are located near the town of Lafitte in Jefferson Parish, Louisiana, on two streams, Goose Bayou and Bayou Dupont that connect the open water area of "The Pen" to the Barataria Bay Waterway.

Problems

Construction of the Mississippi River levee has stopped annual flooding that historically nourished surrounding marshes with sediments, nutrients, and fresh water. This river nourishment counteracted subsidence, saltwater intrusion, and subsequent marsh loss.

Restoration Strategy

The project features include two fixed crest rock weirs with boat bays, across Goose Bayou and Bayou Dupont. The purpose of the project is to manage the sediment-laden fresh water diverted by the Naomi Siphon [a state- and Plaquemines Parish-funded project (BA-03) located along the west bank of the Mississippi River near the community of Naomi]. The two fixed crest weirs will assist in the management of the siphon outfall water by reducing freshwater loss, allowing maximum sediment retention and nutrient uptake, and reducing saltwater intrusion into the project area.

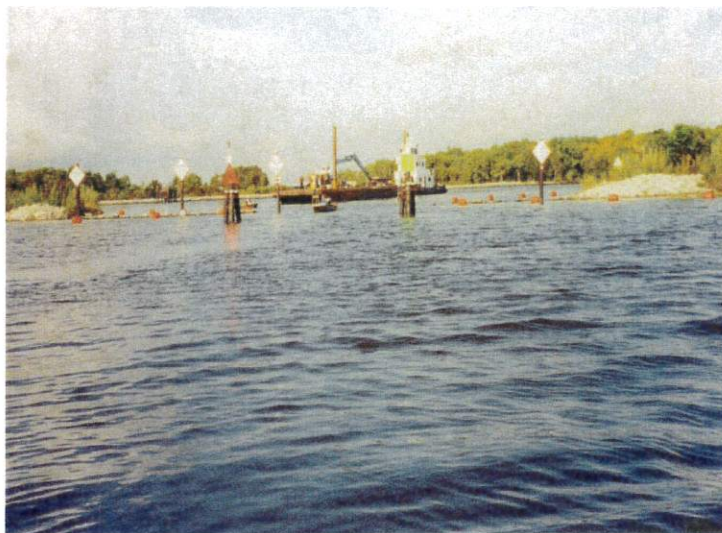

Weirs constructed with a boat bay aid in the effective management of hydrology while still allowing the passage of small boats and vessels.

Progress to Date

This project was combined with the Barataria Bay Waterway East Side Shoreline Protection (BA-26) project for planning and design; however, construction was separate.

The operation of the siphon was reviewed by DNR. A hydraulic analysis was performed and the results were concurred by both agencies. Construction was completed in 2002.

This project is on Priority Project List 5.

For more project information, please contact:



Federal Sponsor:
Natural Resources Conservation Service
Alexandria, LA
(318) 473-7756



Local Sponsor:
Coastal Protection and Restoration Authority
Baton Rouge, LA
(225) 342-4736

Naomi Outfall Management (BA-03c)

 Weir

 Project Boundary

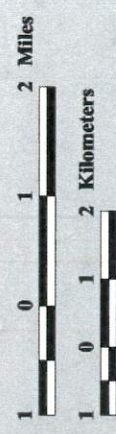
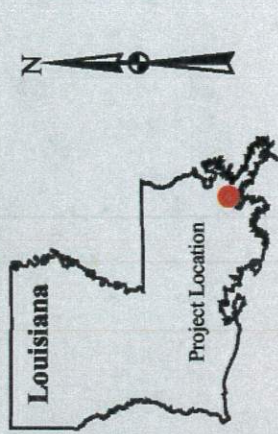

Map Produced By:
U.S. Department of the Interior
U.S. Geological Survey
National Wetlands Research Center
Coastal Restoration Field Station

Background Imagery:
2002 Thematic Mapper Imagery

Map Date: August 27, 2003
Map ID: USGS-NWRC 2003-11-099
Data accurate as of: April 4, 2003



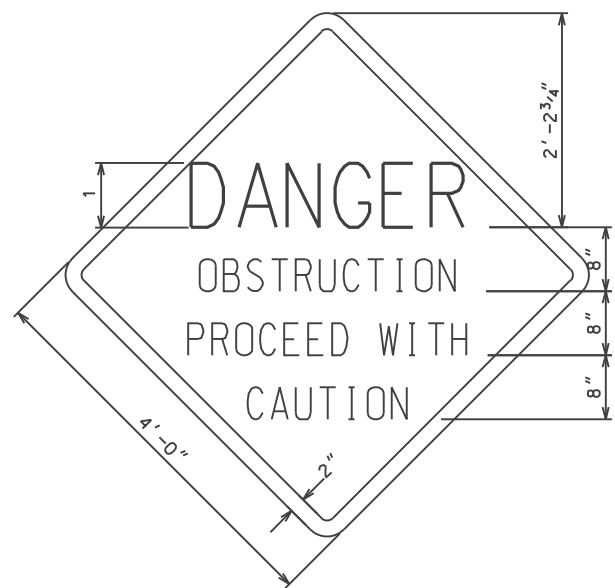

**WARNING SIGN DETAILS
TYPE A**

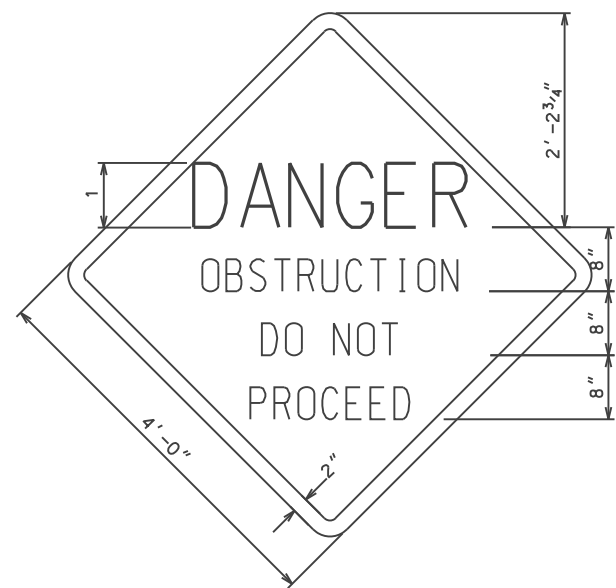

**WARNING SIGN DETAILS
TYPE C**

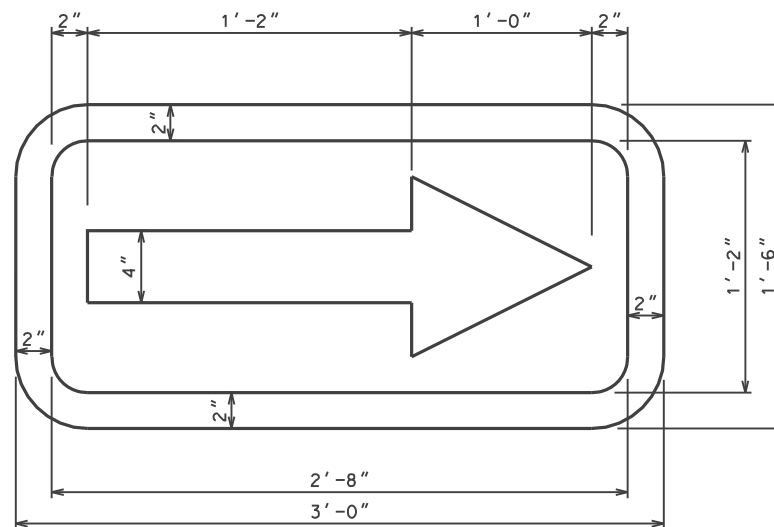

**DIRECTIONAL SIGN DETAILS
(NOT TO SCALE)**

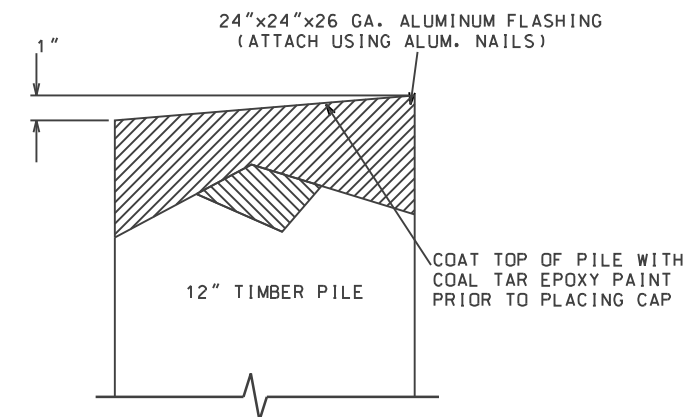

**TYPICAL TIMBER PILE CAP
(NOT TO SCALE)**

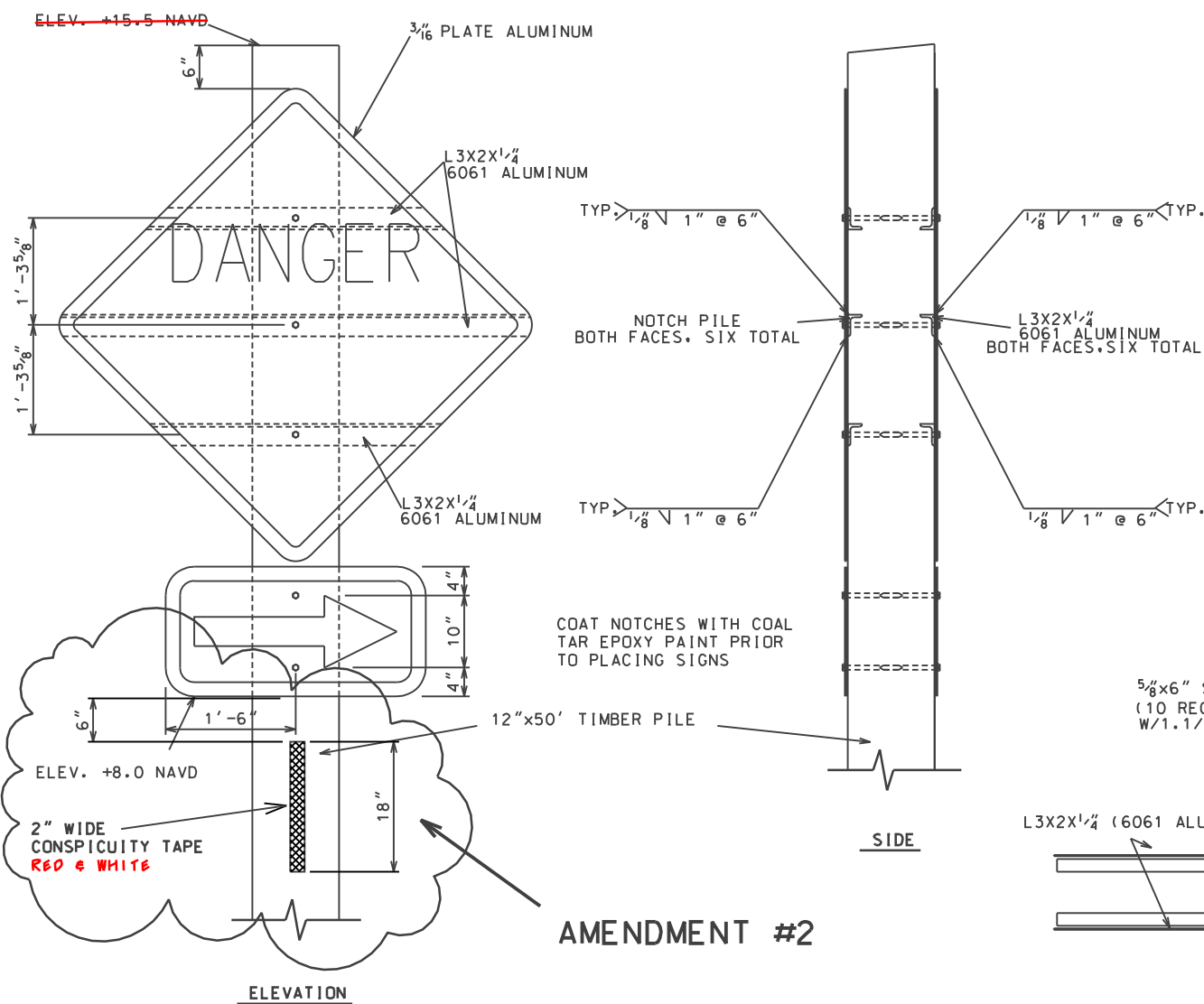

**SIGN TYPE A - DETAILS
(USED AT BOTH STRUCTURES)**

AMENDMENT #2

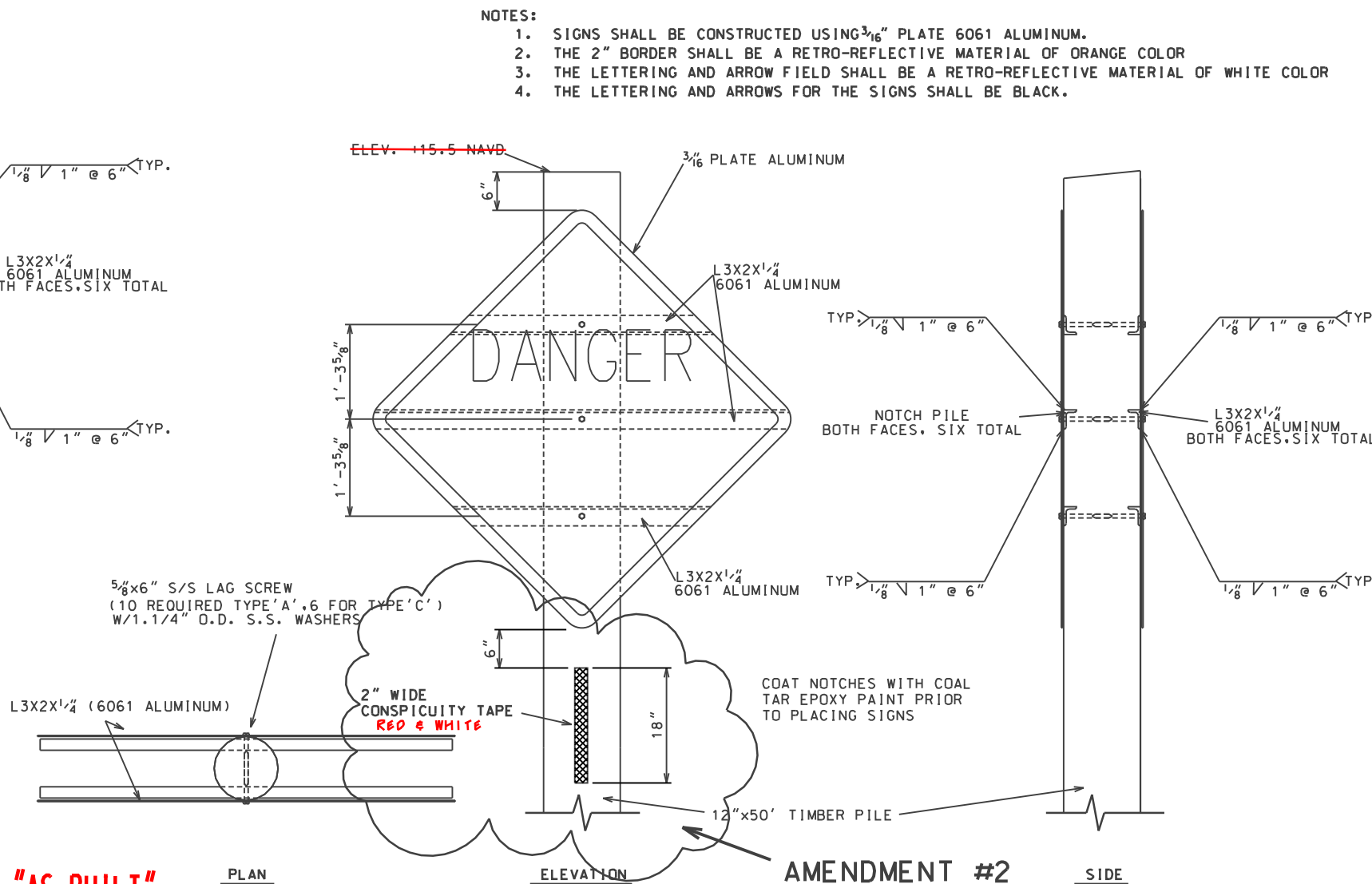

SIGN TYPE C - DETAILS

- NOTES:**
- SIGNS SHALL BE CONSTRUCTED USING 3/16" PLATE 6061 ALUMINUM.
 - THE 2" BORDER SHALL BE A RETRO-REFLECTIVE MATERIAL OF ORANGE COLOR
 - THE LETTERING AND ARROW FIELD SHALL BE A RETRO-REFLECTIVE MATERIAL OF WHITE COLOR
 - THE LETTERING AND ARROWS FOR THE SIGNS SHALL BE BLACK.

"AS-BUILT"

DATE OF COMPLETION 06/19/2002

Designed	C. E. LaFleur	Date	2/98
Drawn	A. J. Gremillion	Approved by	E. J. GERING III
Traced	James N. Moore	Title	STATE CONSERVATION ENGINEER
Checked	James N. Moore	Title	ALABAMA
		Date	12/01

TYPE A & C WARNING SIGN DETAIL
GOOSE BAYOU & BAYOU DUPONT CANAL WEIRS
PROJECT NO. BA-3C
JEFFERSON PARISH, LOUISIANA

NO.	DATE	APPR.	TITLE
A2	03/02	C.E.	

CAD FILE NO.
LA30610A2.DGN
DRAWING NO.
LA-306
SHEET NO 10 OF 12

U.S. DEPARTMENT OF AGRICULTURE - NATURAL RESOURCES CONSERVATION SERVICE

NOTES:

1. ALL 3/4" DIA. ALL THREAD TIE RODS SHALL BE SECURED BY NOTCHED IN PLACE OGEE WASHERS AND TACK WELDED NUTS.
2. 8 WRAPS OF 3/4" DIA. CABLE MEETING FED. SPEC. RR-W-410 D AND 6X19 CLASS STAINLESS STEEL WIRE ROPE BETWEEN THE TWO ROWS OF 3/4" DIA. ALL-THREAD ASTM A-193 GR.B7 STAINLESS STEEL TIE RODS.
3. THE 3/4" DIA. CABLE SHALL BE SECURED USING 3 STAINLESS STEEL CLAMPS.
4. THE TOP ROW OF 3/4" DIA. ALL-THREAD TIE RODS SHALL BE A MINIMUM OF 6" BELOW TOP OF BATTER PILE AND 3" VERTICAL CLEARANCE FROM ADJACENT TIE ROD.
5. THE BOTTOM ROW OF 3/4" DIA. ALL-THREAD TIE-RODS SHALL BE A MINIMUM OF 12" BELOW THE 3/4" DIA. ALL-THREAD ROD ABOVE IT.
6. ALL TIMBER PILES FOR FOUR PILE NAVIGATION AID DOLPHIN SHALL BE 12" x 50'.

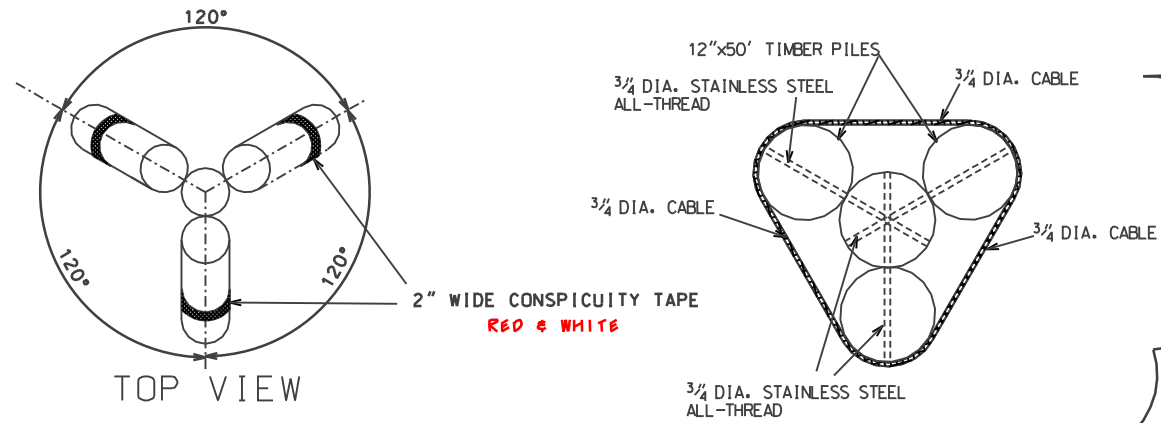

TOP VIEW

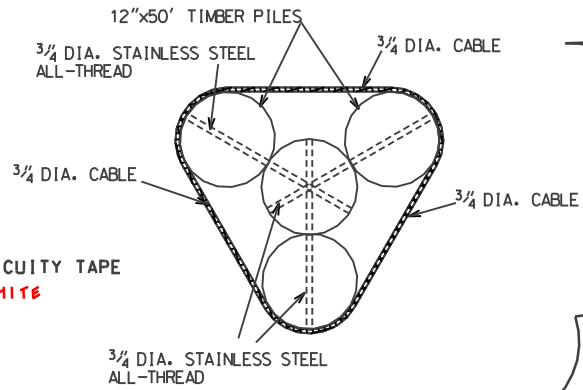

9/16" HOLES FOR 1/2" MOUNTING BOLTS

SECTION-PLAN
A - A

1. NOTCH ROUND TIMBER PILE FOR FLUSH ALUMINUM MOUNTING BRACKET ATTACHMENT.
2. HOLES IN ALUMINUM SHALL BE 1/16" OVERSIZE AND HOLES IN ROUND TIMBER PILE SHALL BE 1/8" OVERSIZE FOR THEIR CORRESPONDING BOLTS.

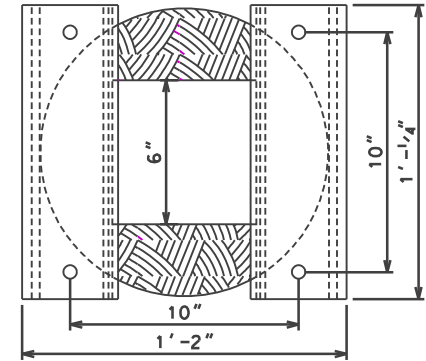

PLAN

DAYMARK NAVIGATION SIGN (SEE DETAILS BELOW)

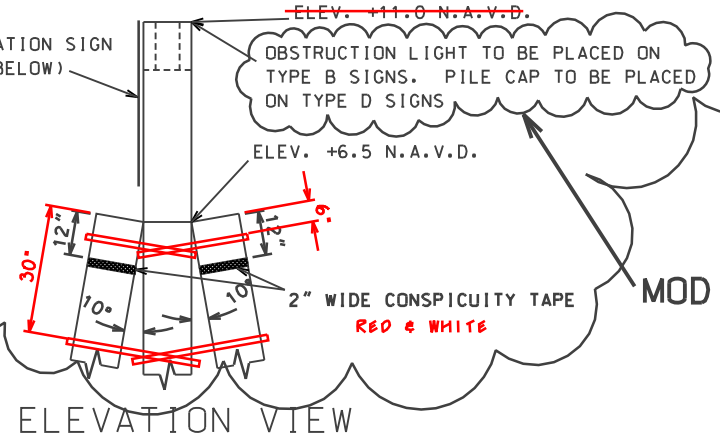

ELEVATION VIEW

NOTE:
U.S. COAST GUARD WILL DETERMINE NUMBERING ON DAYMARKER.

AMENDMENT #2

MODIFICATION #1

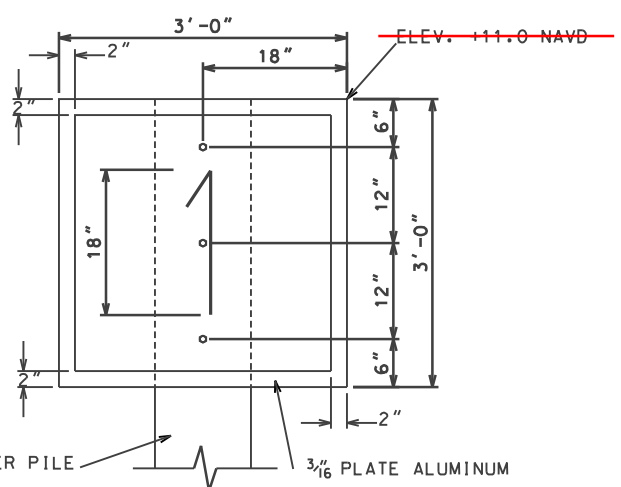

DAYMARK NAVIGATION AID
(PORT SIDE - ODD NUMBER)

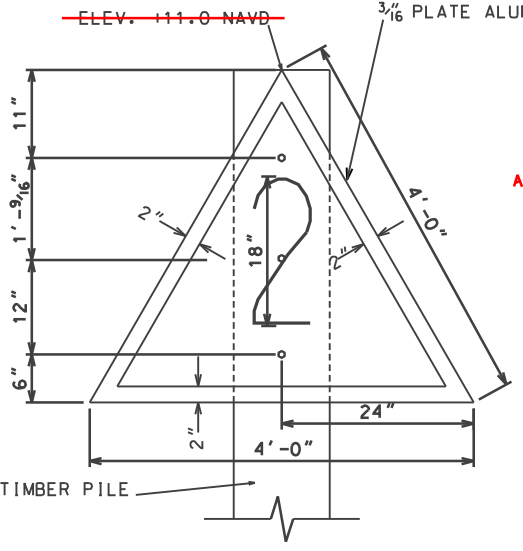

DAYMARK NAVIGATION AID
(STARBOARD SIDE - EVEN NUMBER)

SIGN DETAIL - TYPE B & TYPE D

NOTES:

1. SEE DETAILS ON SHEET 12 FOR SIGN PLACEMENT LOCATIONS.
2. THE BORDER ON THE STARBOARD DAYMARK WILL BE A RETRO-REFLECTIVE MATERIAL OF DARK RED COLOR. THE AREA INSIDE THE BORDERS WILL BE A MATERIAL OF LIGHT RED COLOR. THE NUMBERS WILL BE DARK RED IN ACCORDANCE W/ PLATE 1 OF U.S. COAST GUARD'S U.S. AIDS TO NAVIGATION SYSTEM.
3. THE BORDER ON THE PORT SIDE DAYMARK WILL BE A RETRO-REFLECTIVE MATERIAL OF DARK GREEN COLOR. THE AREA INSIDE THE BORDER WILL BE A MATERIAL OF LIGHT GREEN COLOR. THE NUMBERS WILL BE DARK GREEN IN ACCORDANCE W/ PLATE 1 OF U.S. COAST GUARD'S U.S. AIDS TO NAVIGATION SYSTEM.
4. ALL DAYMARK NAVIGATION AIDS SHALL ABIDE BY U.S.C.G. REGULATIONS.
5. SIGNS SHALL BE SECURED TO TIMBER PILE WITH 3-5/8"x8" STAINLESS STEEL LAG SCREWS WITH 1 1/4" O.D. S.S. WASHER.

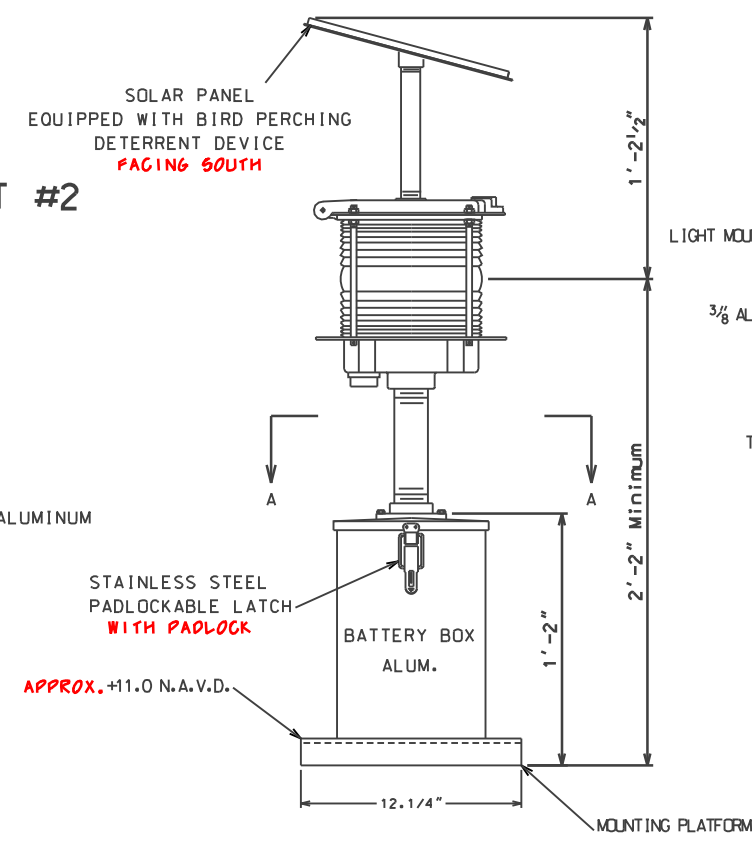

ELEVATION

2.5 SEC. DAYLIGHT
ALUM.

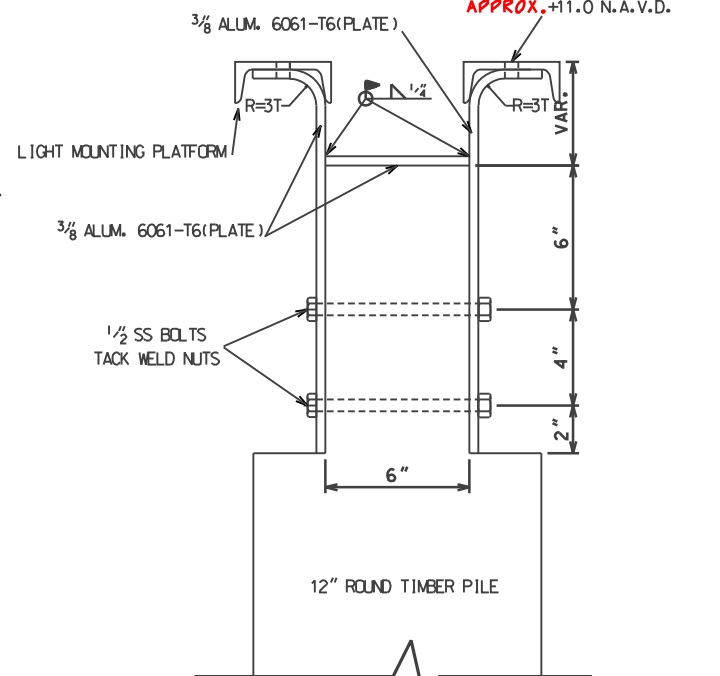

ELEVATION

MOUNTING DETAILS-2.5 SEC. DAYLIGHT
ALUM.

"AS-BUILT"

DATE OF COMPLETION 08/19/2002

SIGN DETAIL - TYPE B

DESIGNED	Cherie LaFleur	DATE	9/99
DRAWN	A. J. Gremillion	DATE	9/99
TITLED	Traced	DATE	02/00
CHECKED	James N. Moore	DATE	02/00
APPROVED	E.J. GIERING III	DATE	12/01
TITLE	STATE CONSERVATION ENGINEER		

TYPE B WARNING SIGN DETAILS
BAYOU DUPONT CANAL AND GOOSE BAYOU WEIR
PROJECT NO. BA-3C
JEFFERSON PARISH, LOUISIANA
 U.S. DEPARTMENT OF AGRICULTURE - NATURAL RESOURCES CONSERVATION SERVICE

NO.	DATE	APPR.	TITLE
A2	03/02	C.L.S.	C.E.
M	03/02	B.A.S.	C.E.

CAD FILE NO.
LA30611M1.DGN
DRAWING NO.
LA-306
SHEET NO 11 OF 12